

No.	L	B	T	Pcs.	Colli
1	1400	650	25	1	1
2	1400	650	25	1	1
3	788	810	40	2	1
4	1390	690	33	1	1

BABYBETT "MORGENROTH"

A



Ø 8x30 mm

x12

B

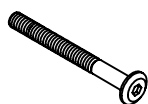

M6x60mm

x8

C



M6x10x14 mm

x8

D

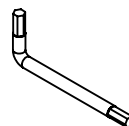

x1

E

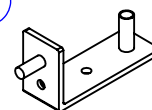

x4

F



M4x10 mm

x4

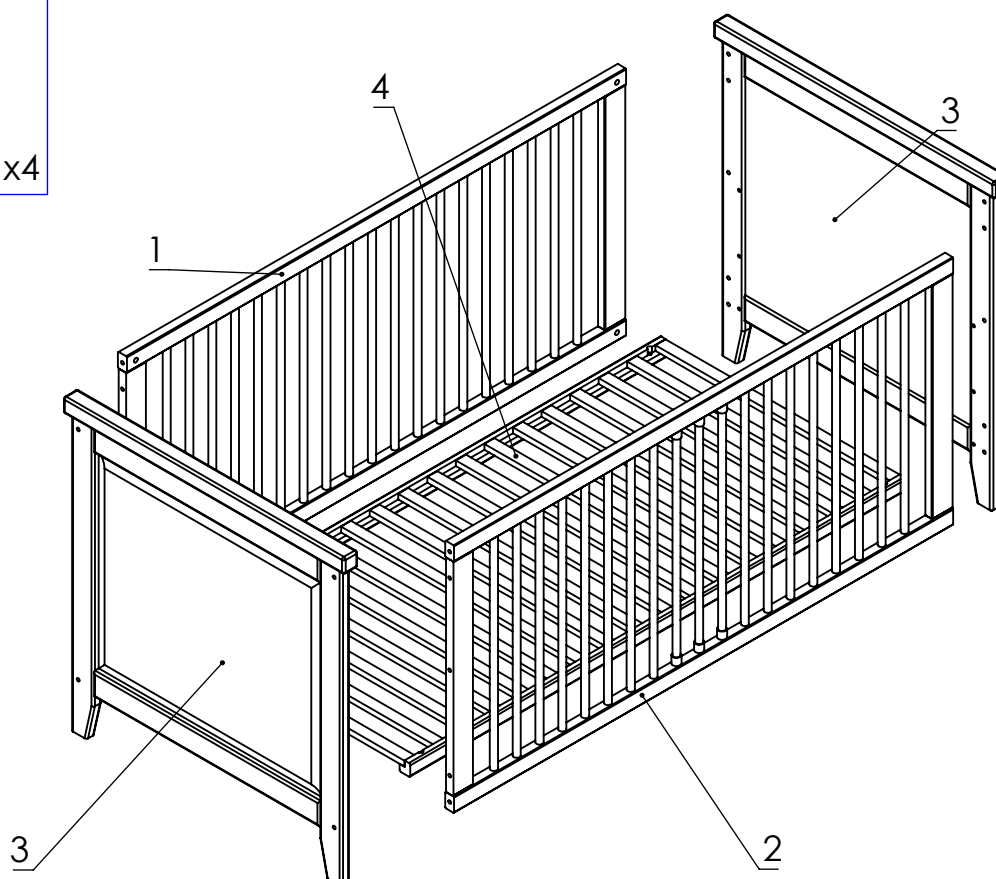

1.

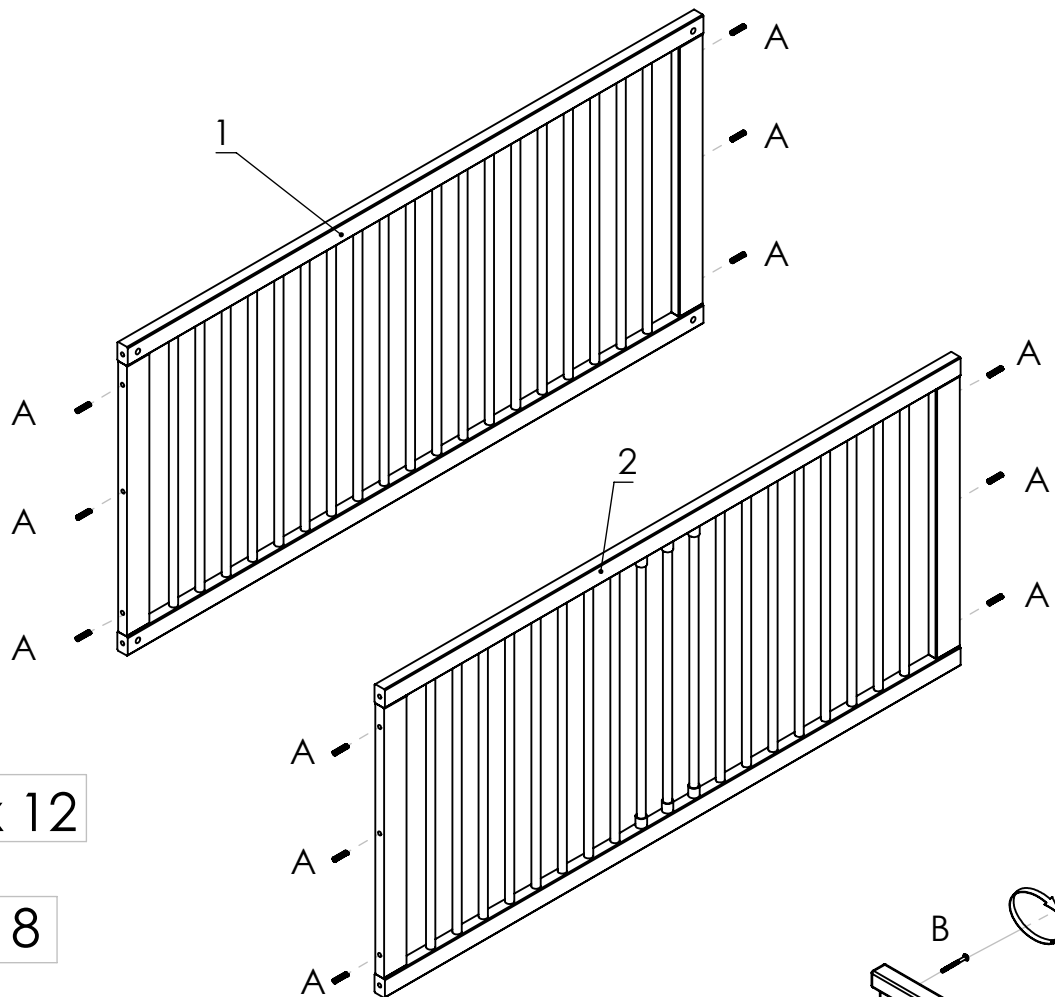

A x 12

B x 8

C x 8

D x 1

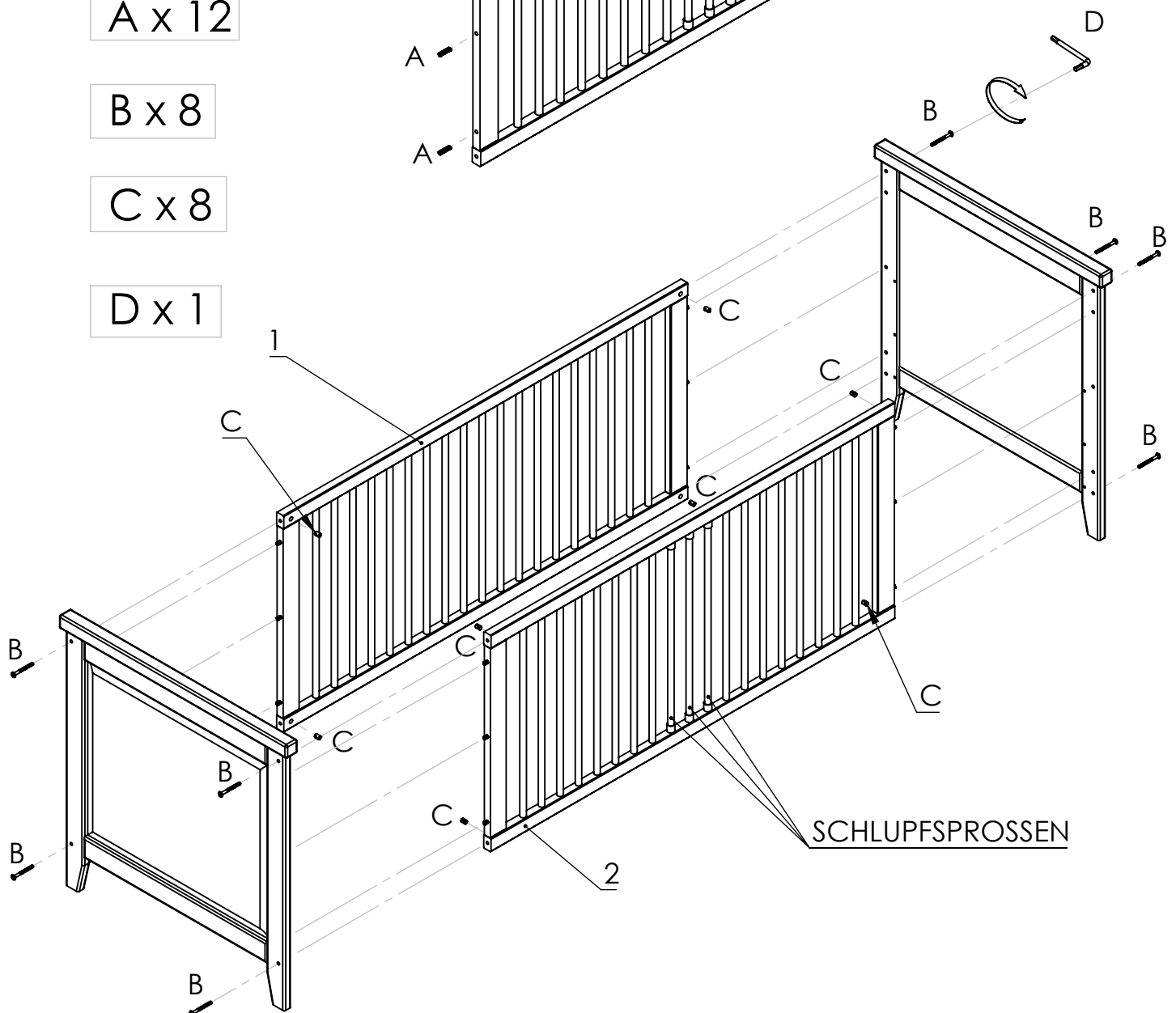

2.

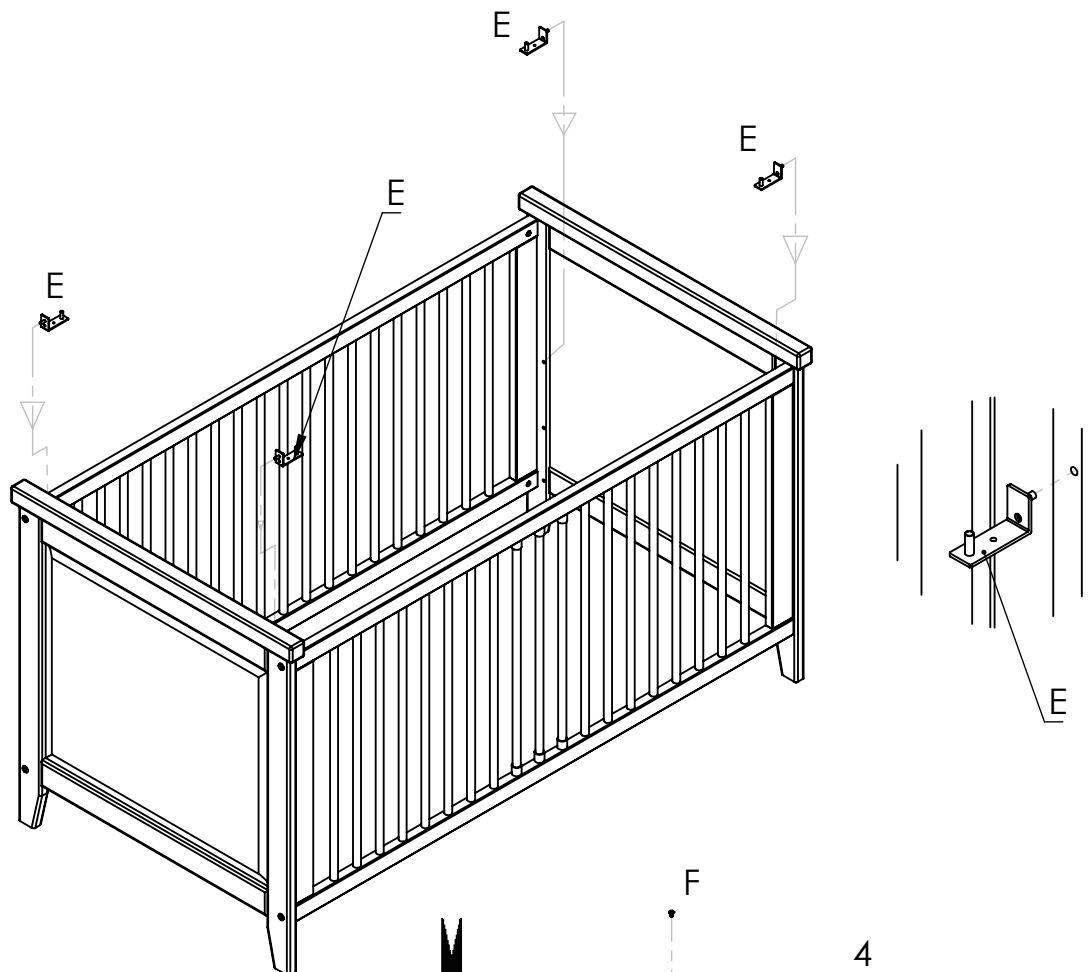

$E \times 4$

$F \times 4$

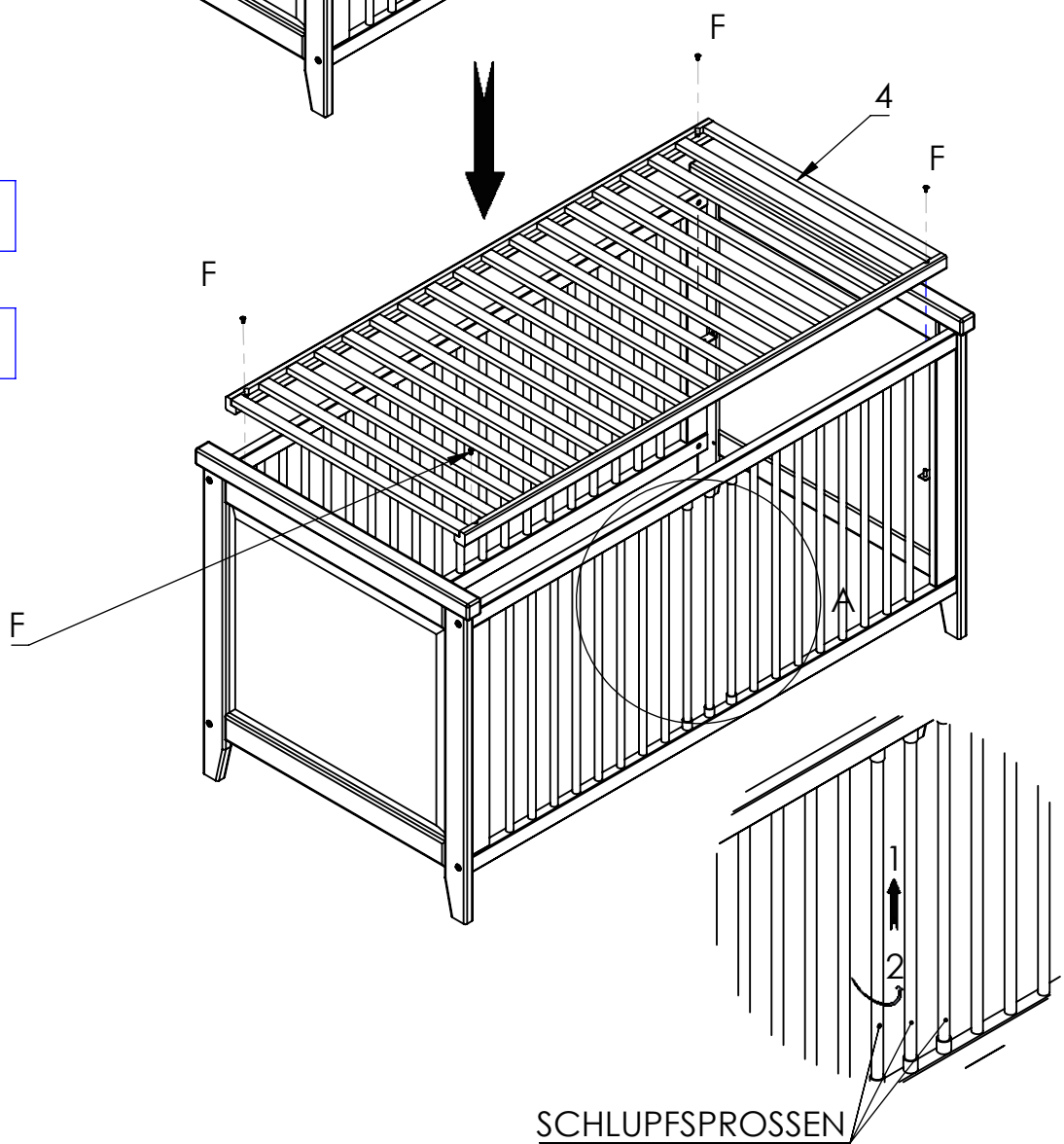

SCHLUPFSPROSSEN

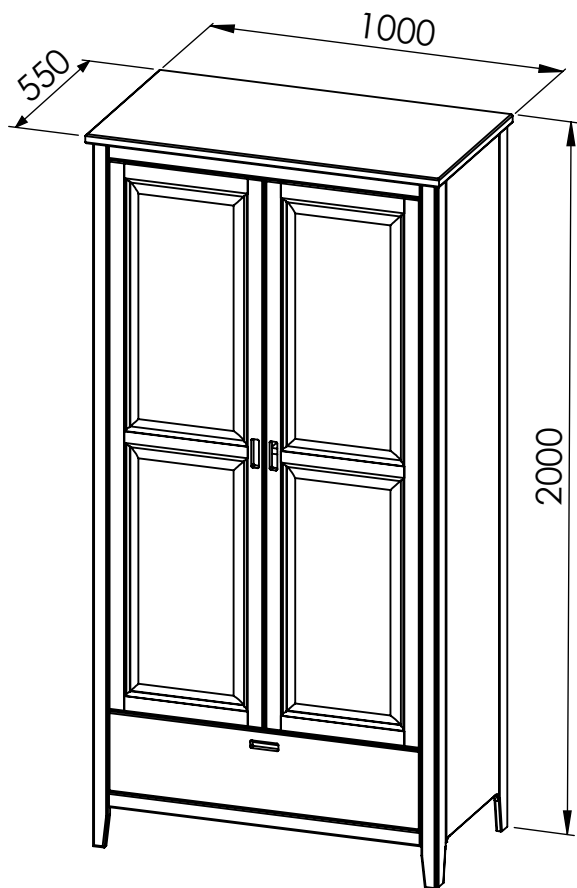

No.	L	B	T	Pcs.	Colli
1	1000	550	25	1	2
2	1975	535	42	1	1
3	1975	535	42	1	1
4	1581	513	16	1	1
5	938	513	16	1	2
6	1543	439	19	1	1
7	1543	439	19	1	1
8	882	225	19	1	2
9	400	177	16	1	2
10	400	177	16	1	2
11	844	177	16	1	2
12	858	398	3.2	1	2
13	938	80	16	1	1
14	938	98	42	1	2
15	400	40	26	2	2
16	459	505	16	3	2
17	886	42	18	1	1
18	80	60	26	6	2
19	455	40	18	2	2
20	1841	478.5	3.2	2	1

Schrank 2 Türen "MORGENROTH"

A $\varnothing 8 \times 30 \text{ mm}$ 46x	B $\varnothing 3.5 \times 35 \text{ mm}$ 14x	C 23x	D 4x	E $\varnothing 3 \times 16 \text{ mm}$ 20x	F 3x	G $\varnothing 15 \text{ mm}$ 26x
H $\varnothing 6.5 \times 50 \text{ mm}$ 3x	I 6x	J $\varnothing 4.5 \times 11 \text{ mm}$ 4x	K 310 mm 2x	L M4x12mm 2x	M 12x	N 6x
O $\varnothing 2.9 \times 19 \text{ mm}$ 36x	P LEIM 1x	Q 1x				

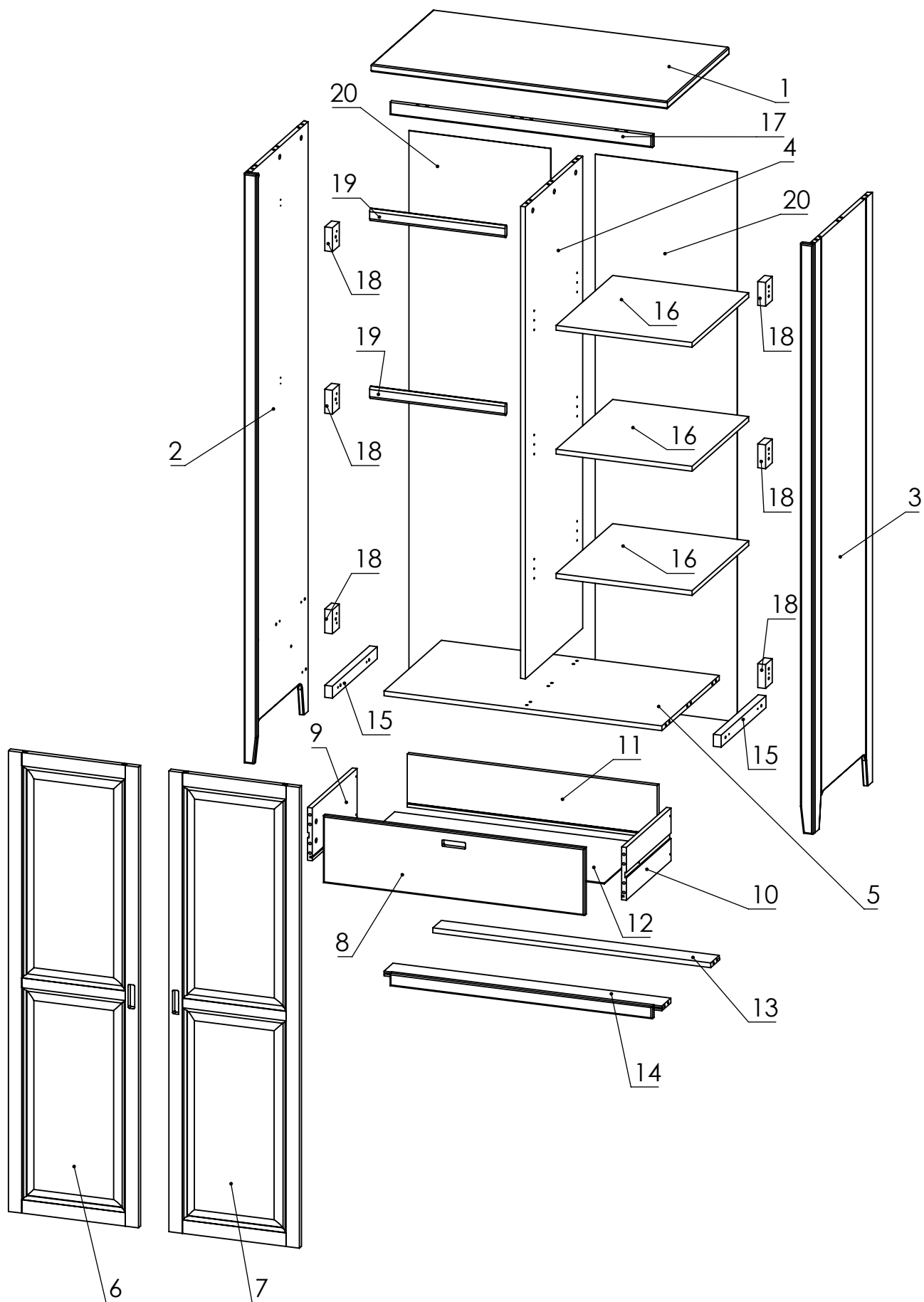

1.

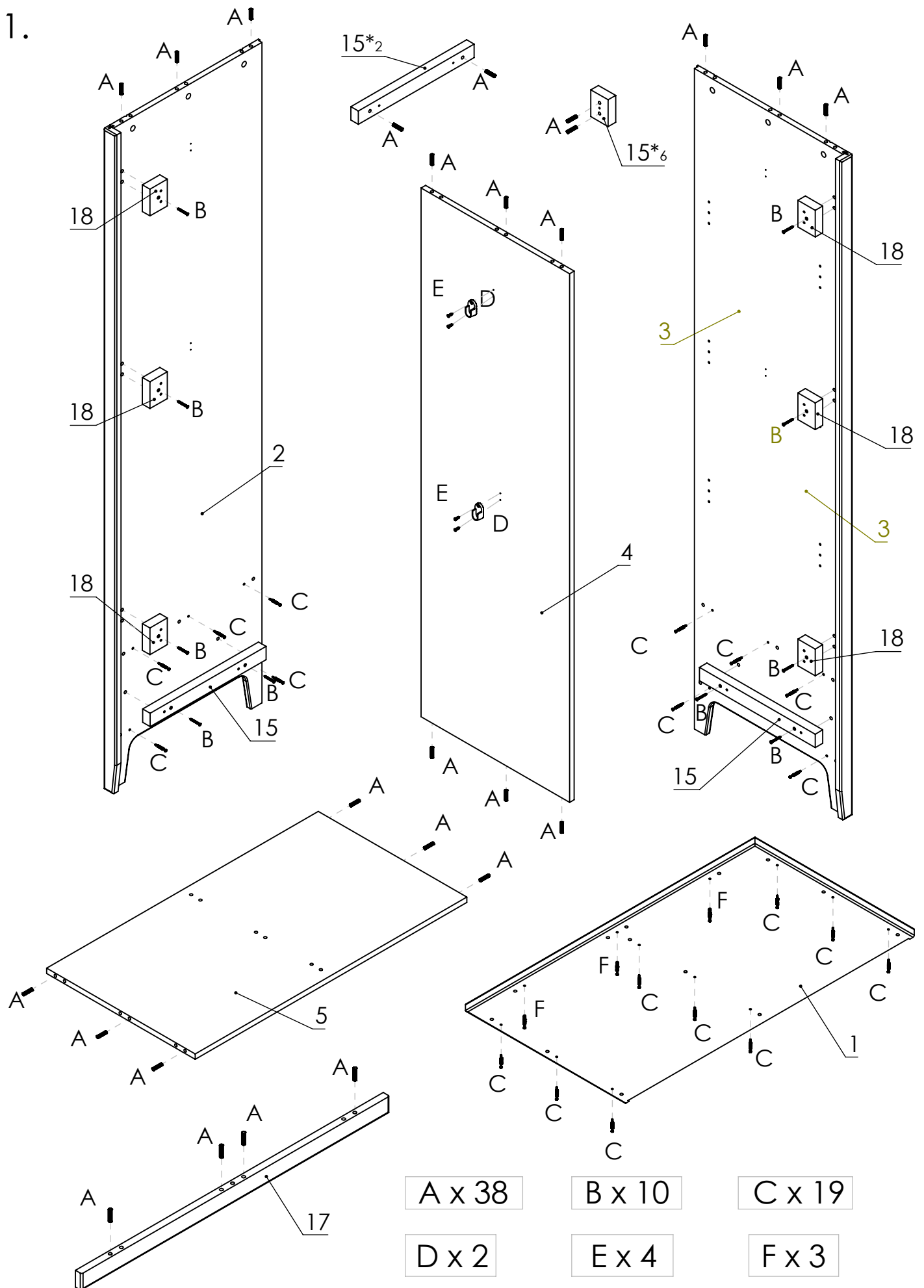

2.

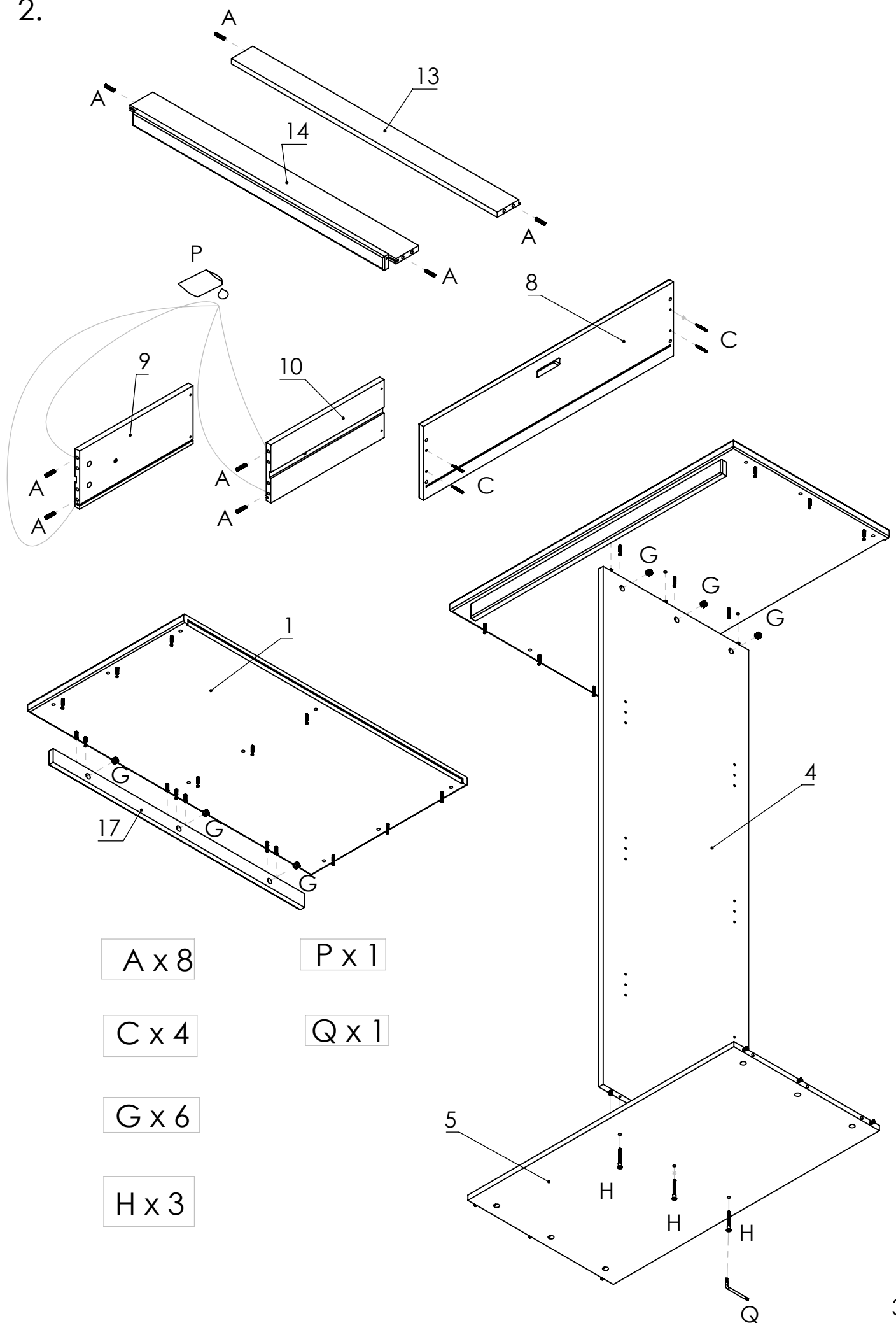

A x 8

P x 1

C x 4

Q x 1

G x 6

H x 3

3.

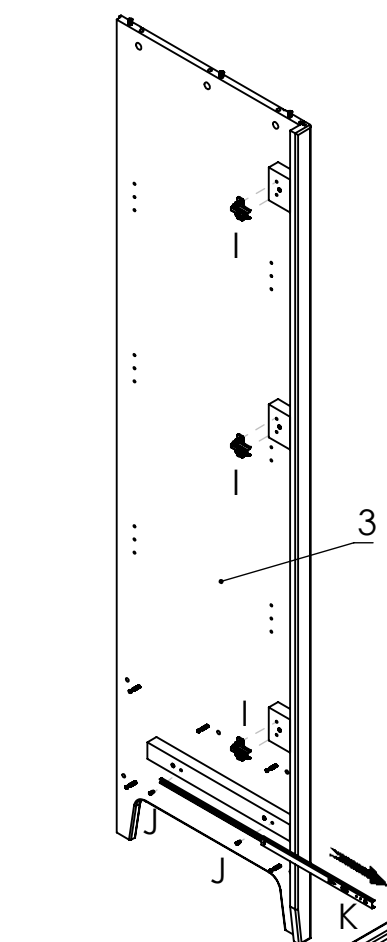
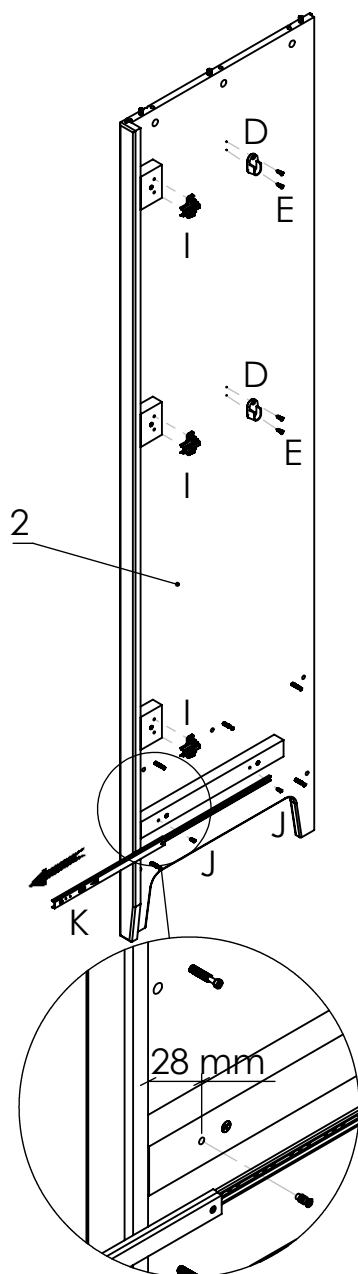

D x 2

E x 4

I x 6

J x 4

K x 2

G x 16

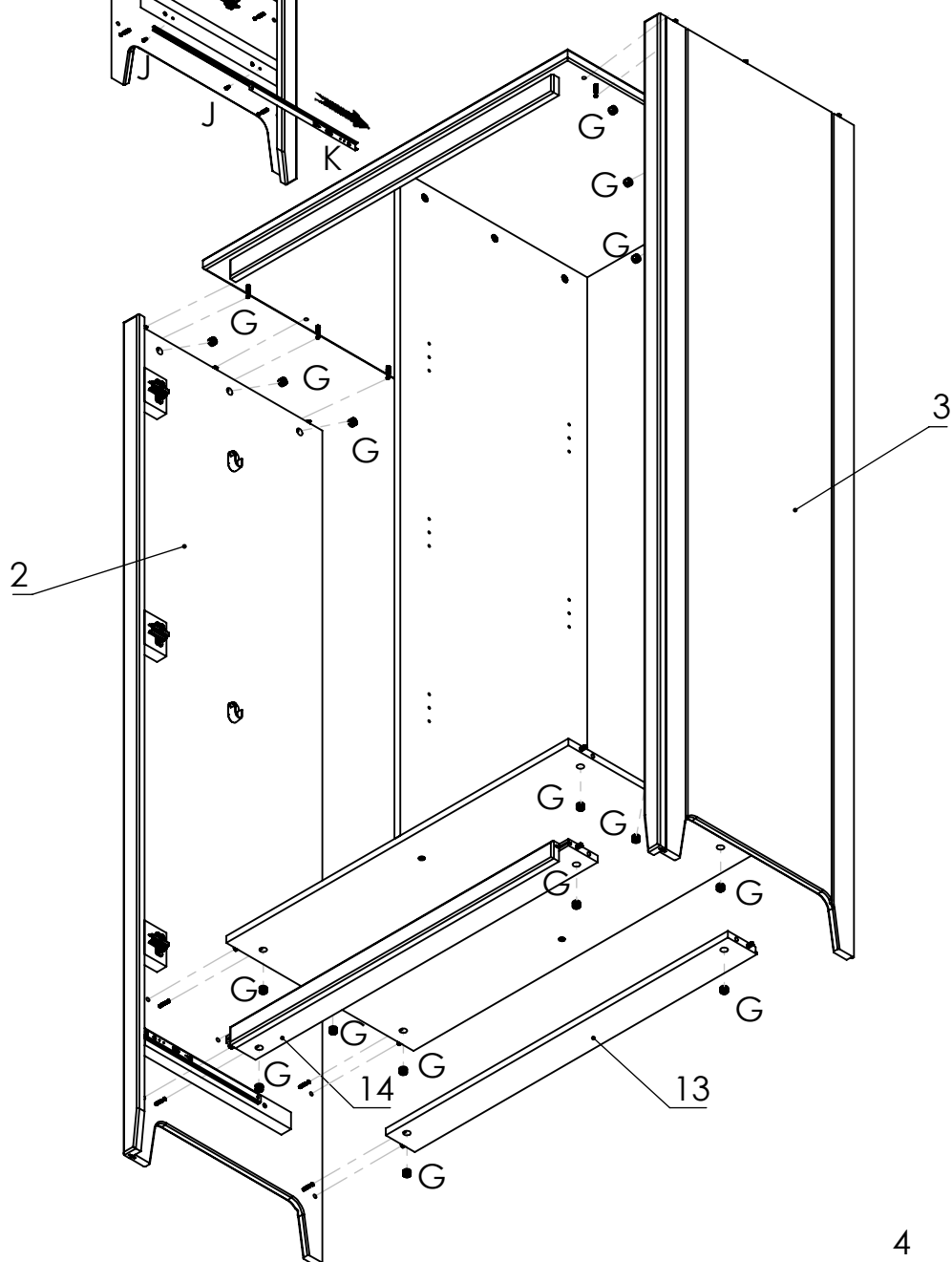

4.

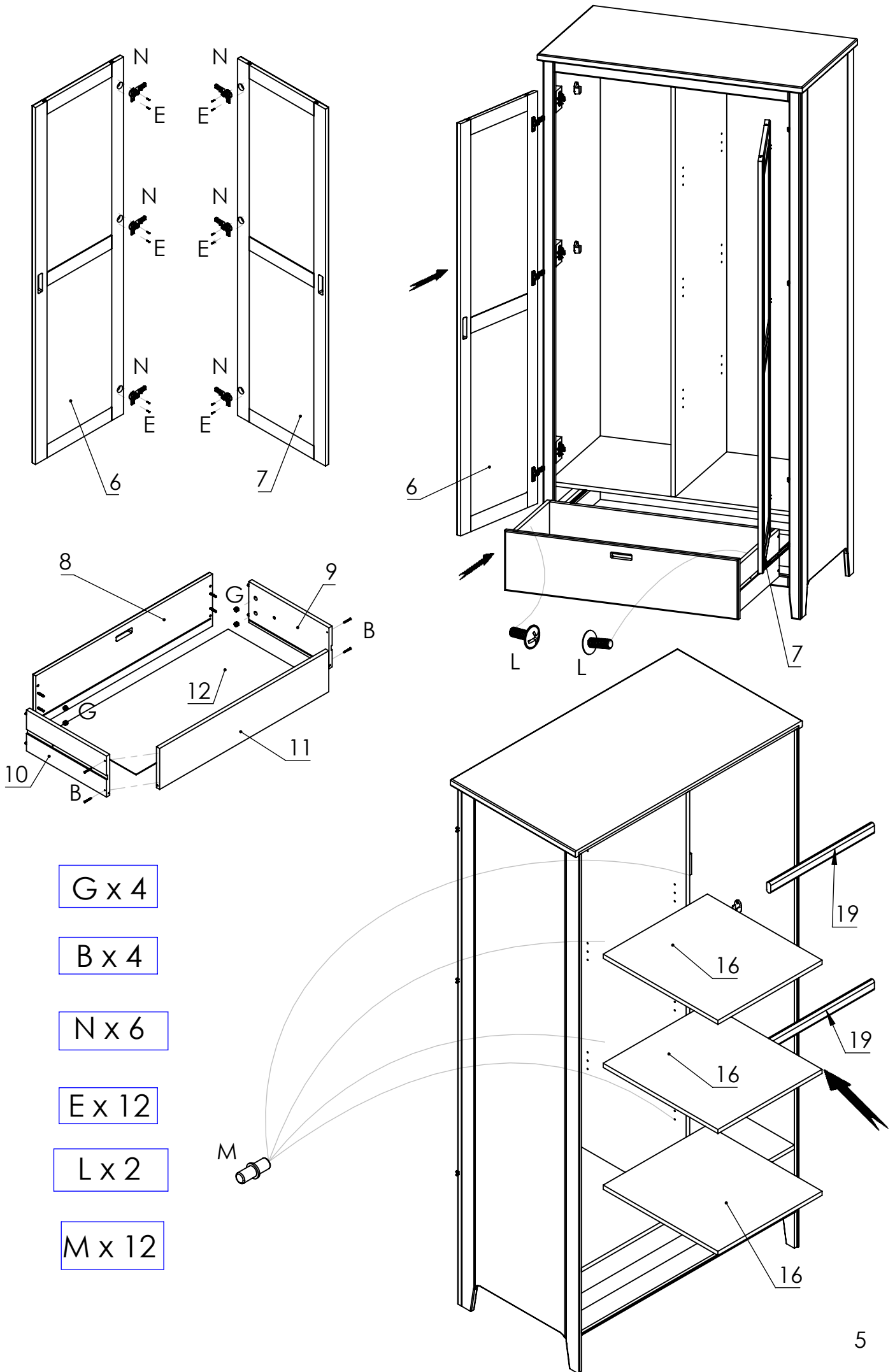

5.

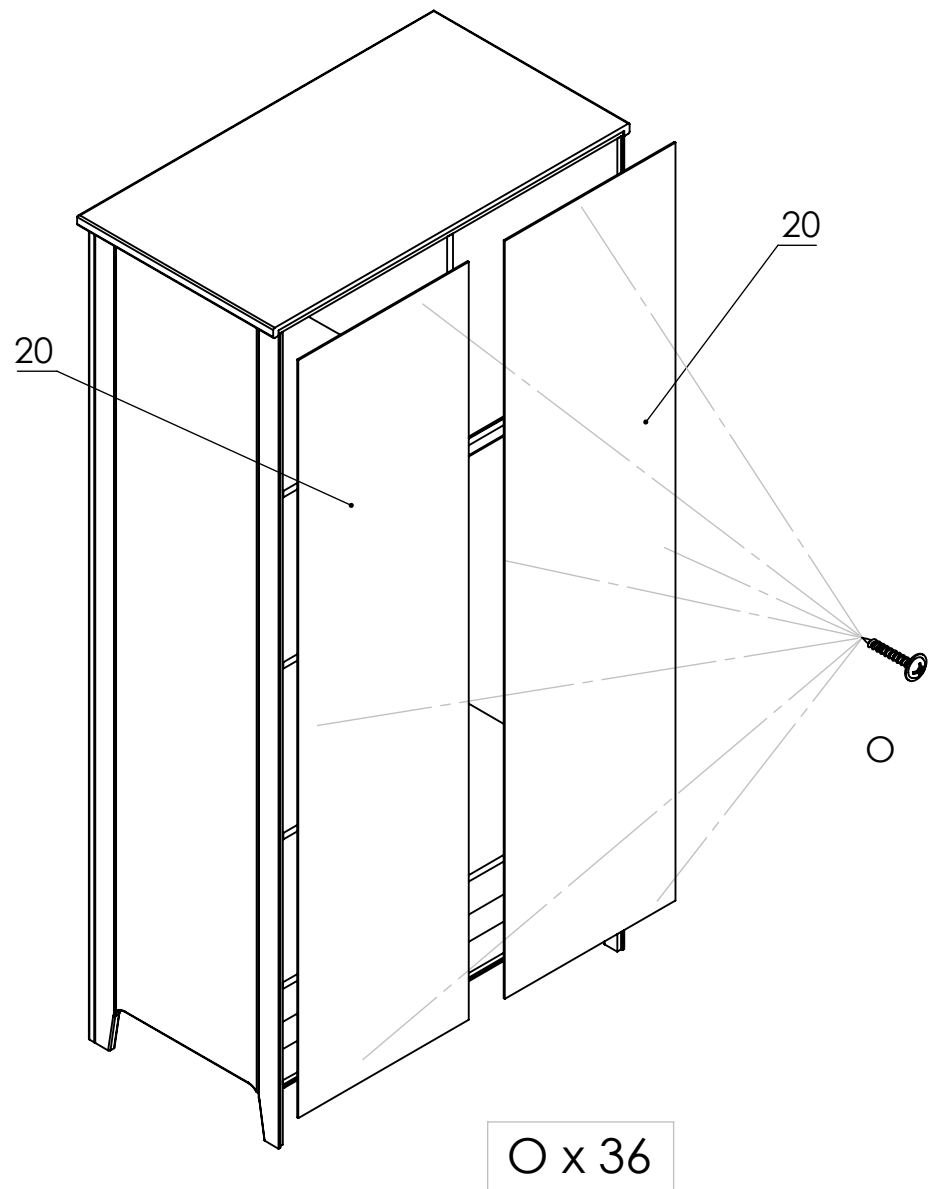

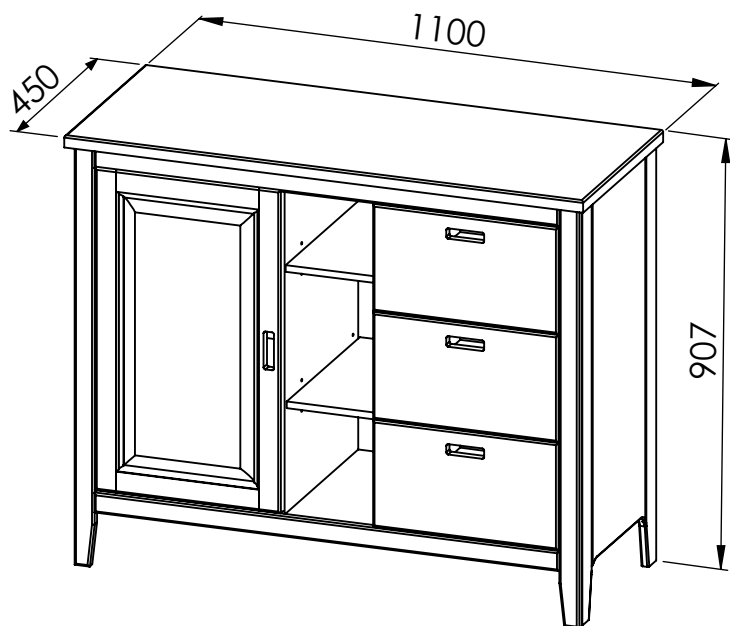

No.	L	B	T	Pcs.	Colli
1	1100	450	25	1	1
2	882	435	42	1	2
3	882	435	42	1	2
4	726	413	16	1	2
5	726	413	16	1	2
6	1038	435	42	1	1
7	679	393	19	1	2
8	406	410	14	1	1
9	188	410	14	2	1
10	393	225	19	3	2
11	400	177	16	3	1
12	400	177	16	3	1
13	340	177	16	3	1
14	398	354	3.2	3	1
15	400	40	26	3	1
16	80	60	26	2	2
17	748	426	3.2	1	2
18	748	426	3.2	1	2
19	748	204	3.2	1	2
20	986	42	18	1	1

Wickelkommode "MORGENROTH"

A $\varnothing 8 \times 30 \text{ mm}$ 50x	B $\varnothing 3.5 \times 35 \text{ mm}$ 20x	C $\varnothing 3 \times 30 \text{ mm}$ 30x	D $\varnothing 3 \times 30 \text{ mm}$ 3x	E $\varnothing 30 \times 10 \text{ mm}$ 6x	F $\varnothing 4.5 \times 11 \text{ mm}$ 12x	G 2x
H 2x	I $\varnothing 3 \times 16 \text{ mm}$ 4x	J $\varnothing 15 \text{ mm}$ 33x	K $\varnothing 6.5 \times 50 \text{ mm}$ 6x	L $M4 \times 12 \text{ mm}$ 6x	M $\varnothing 4 \times 12 \text{ mm}$ 12x	N $\varnothing 2.9 \times 19 \text{ mm}$ 36x
O LEIM 1x	P $\varnothing 3 \times 16 \text{ mm}$ 1x					

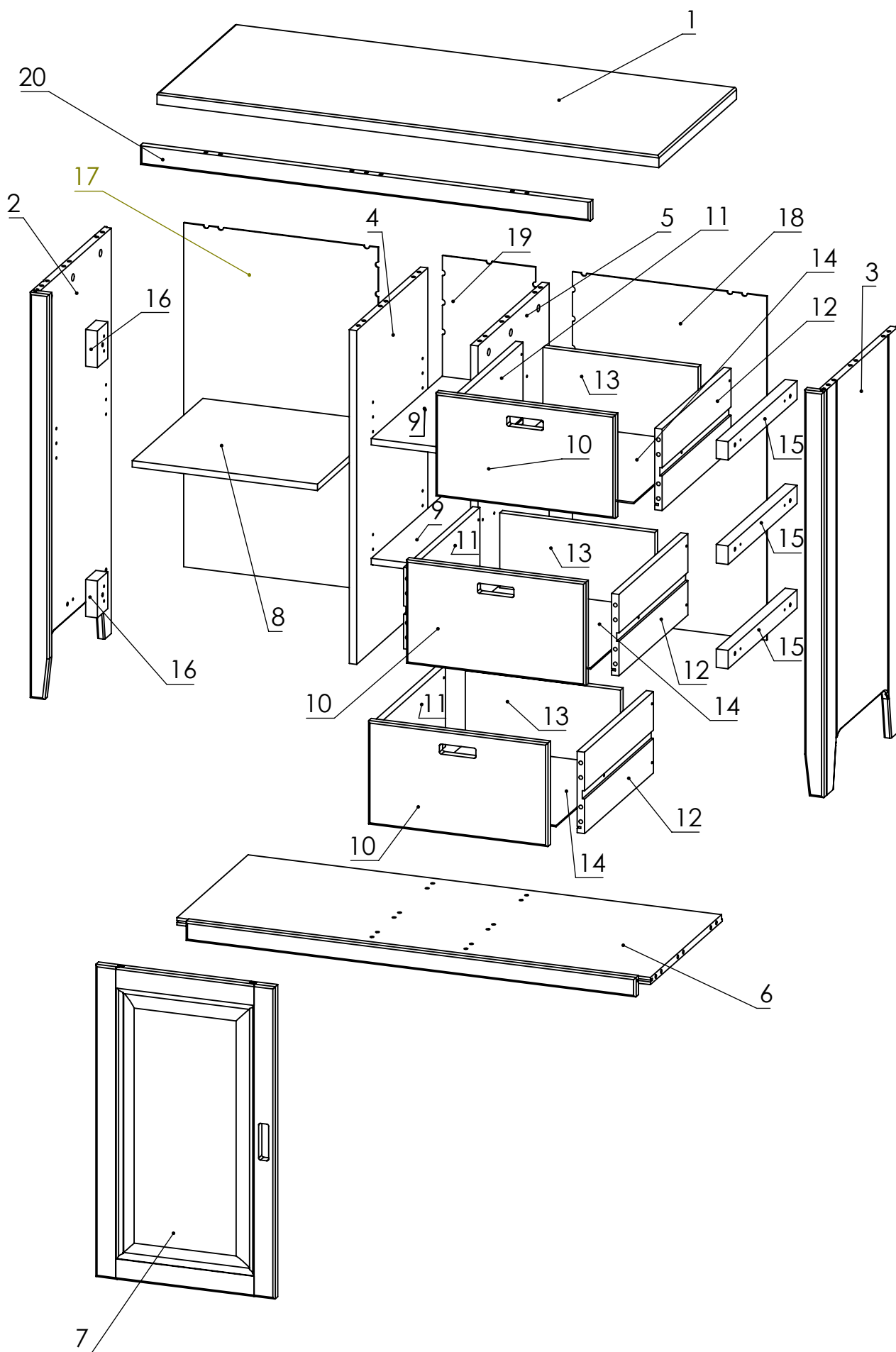

1.

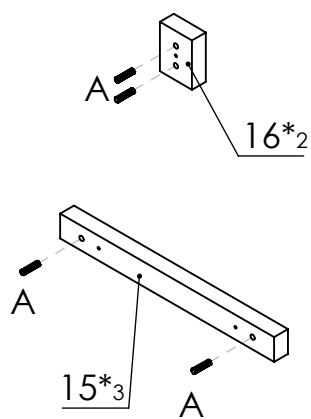

A x 32

B x 8

C x 18

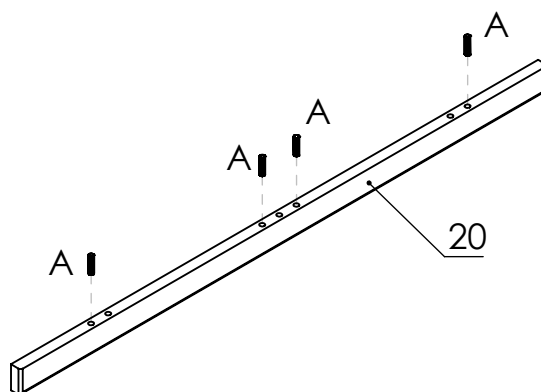
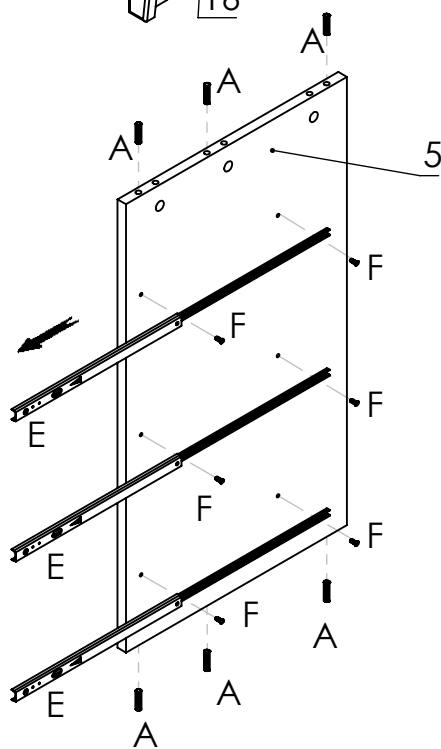
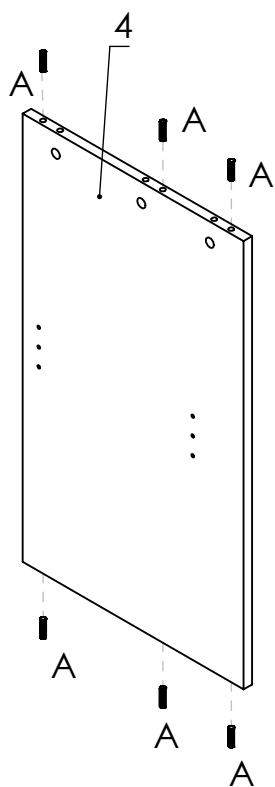
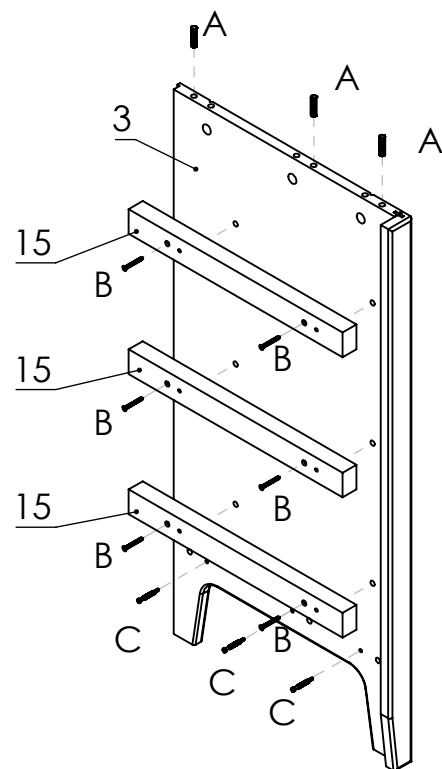
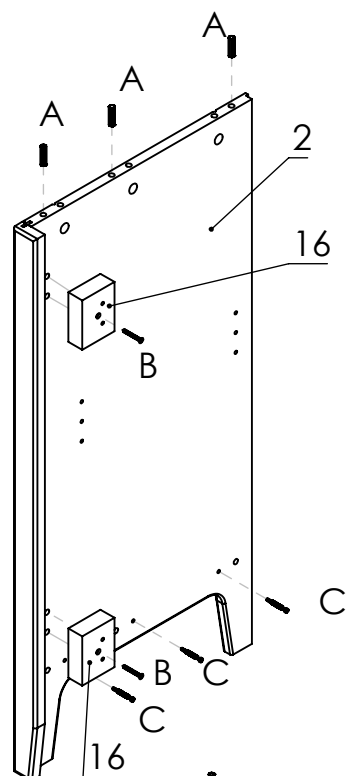

D x 3

E x 3

F x 6

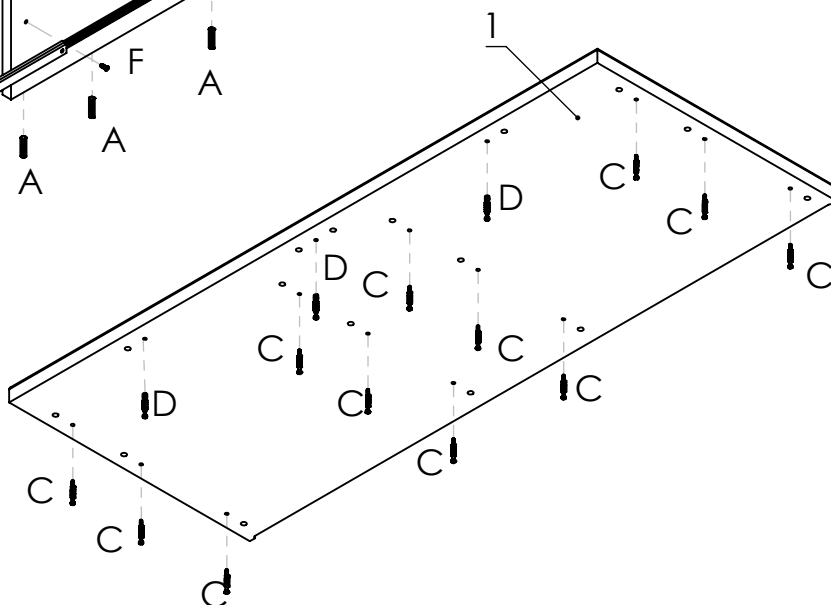

2.

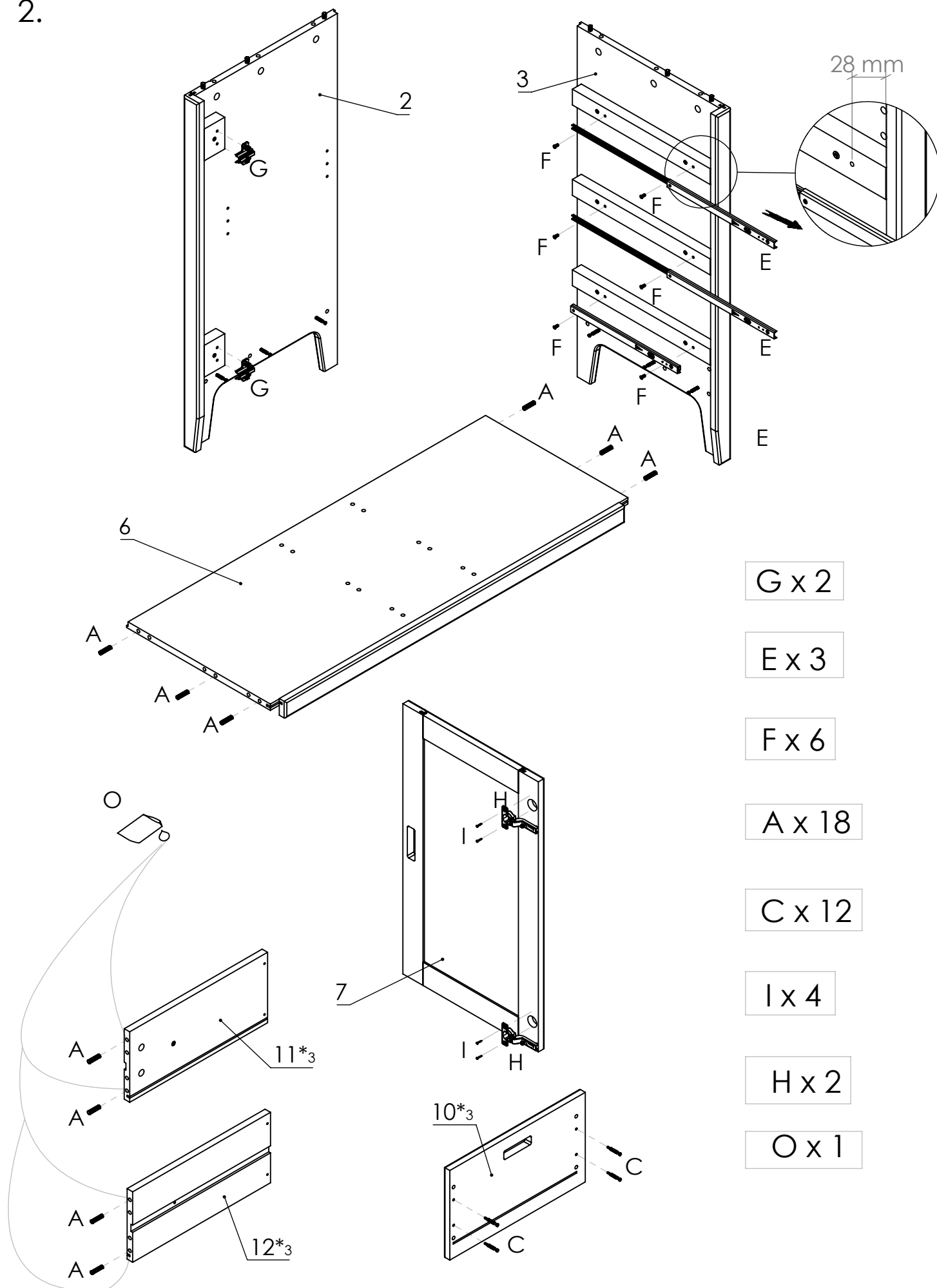

G x 2

E x 3

F x 6

A x 18

C x 12

I x 4

H x 2

O x 1

3.

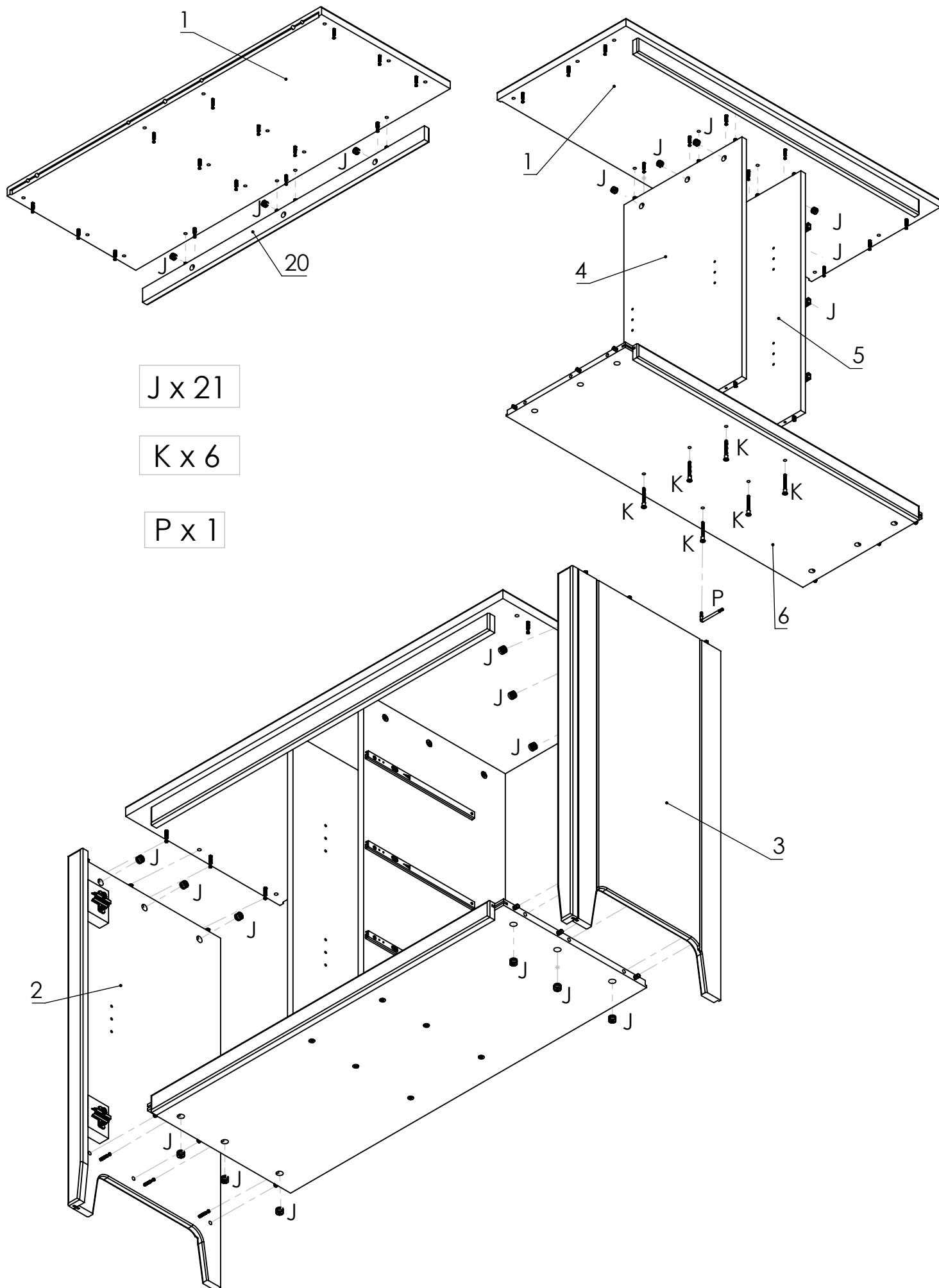

4.

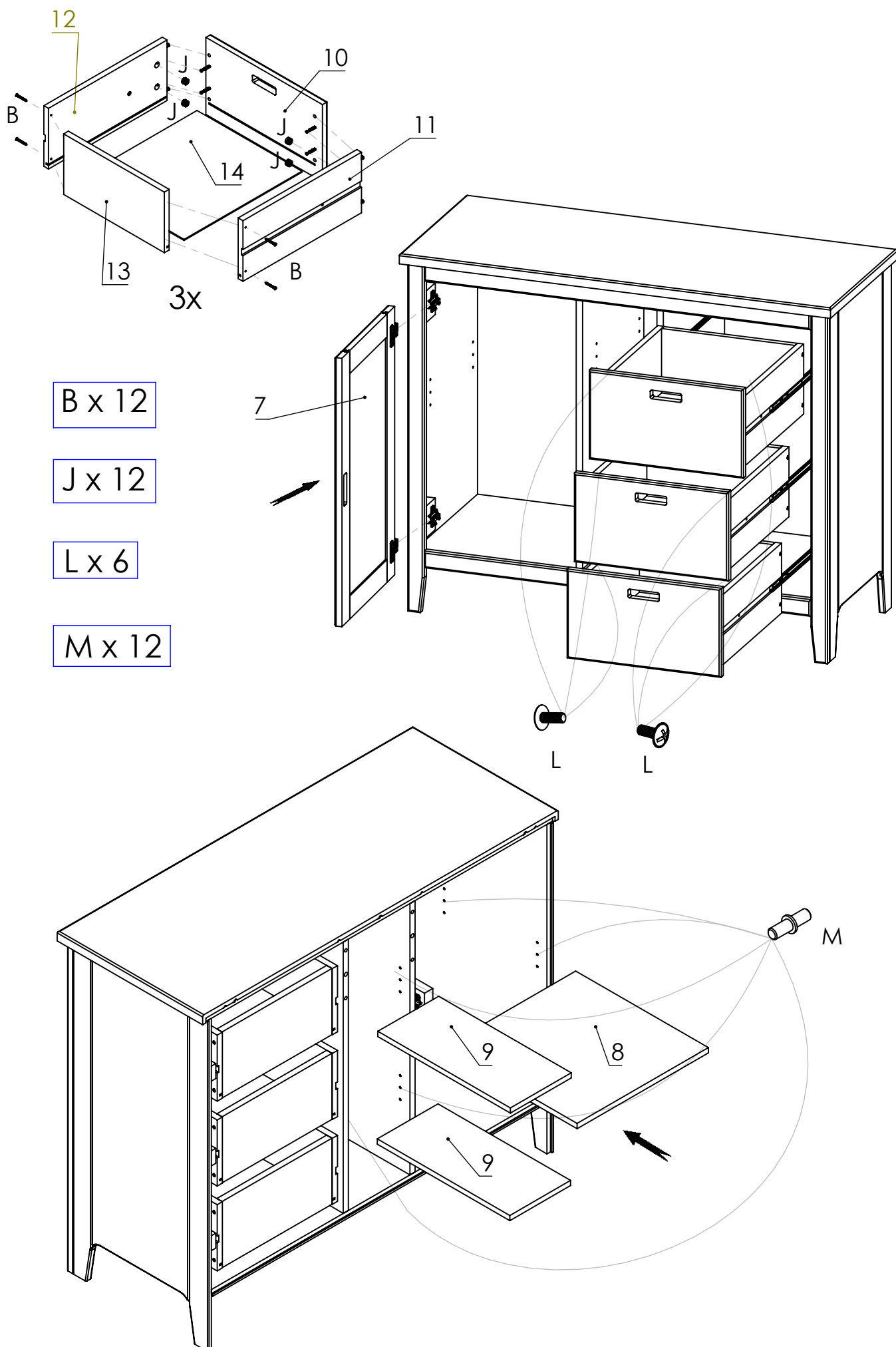

5.

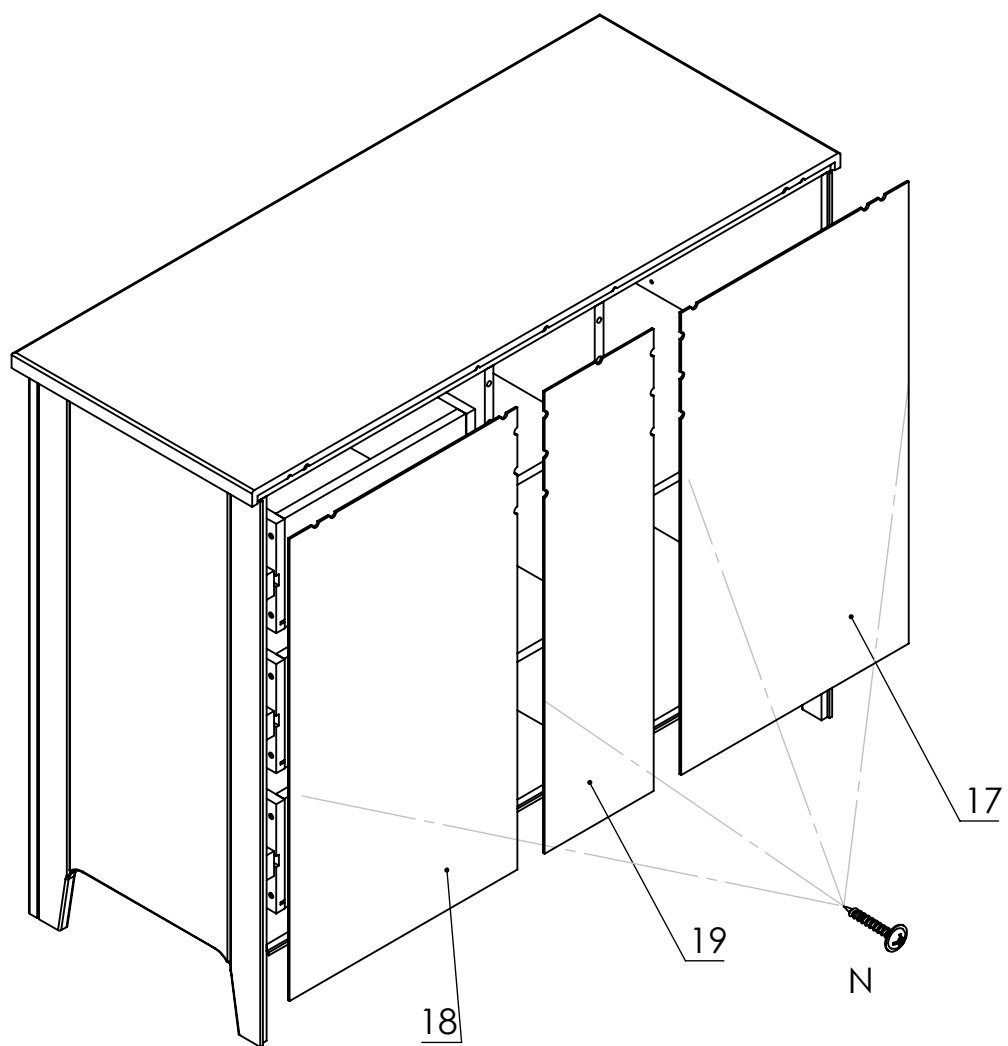

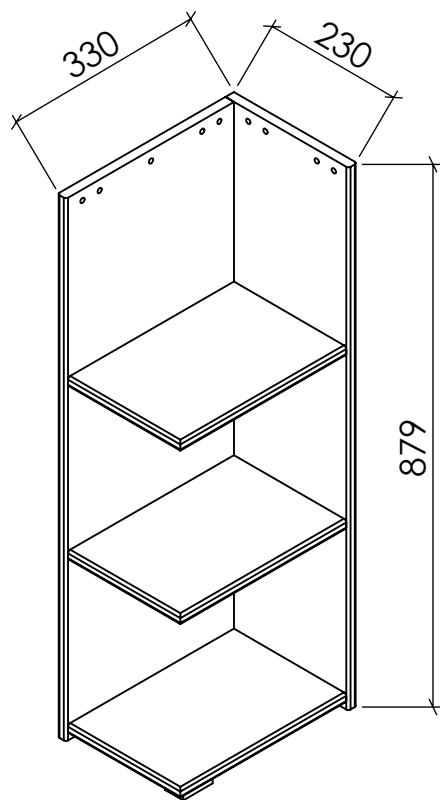

N x 36

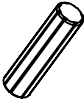
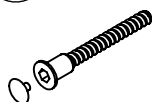
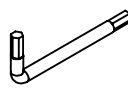

No.	L	B	T	Pcs.	Colli
1	879	230	16	1	1
2	879	314	16	1	1
3	310	210	16	2	1
4	310	210	16	1	1
5	55	34	10	1	1

Regal für Wickelkommode "MORGENROTH"

<p>A</p>  <p>Ø 8x30 mm 19x</p>	<p>B</p>  <p>Ø 6.5x50 mm 15x</p>	<p>C</p>  <p>1x</p>	<p>D</p>  <p>Ø 3x20mm 2x</p>
--	--	---	--

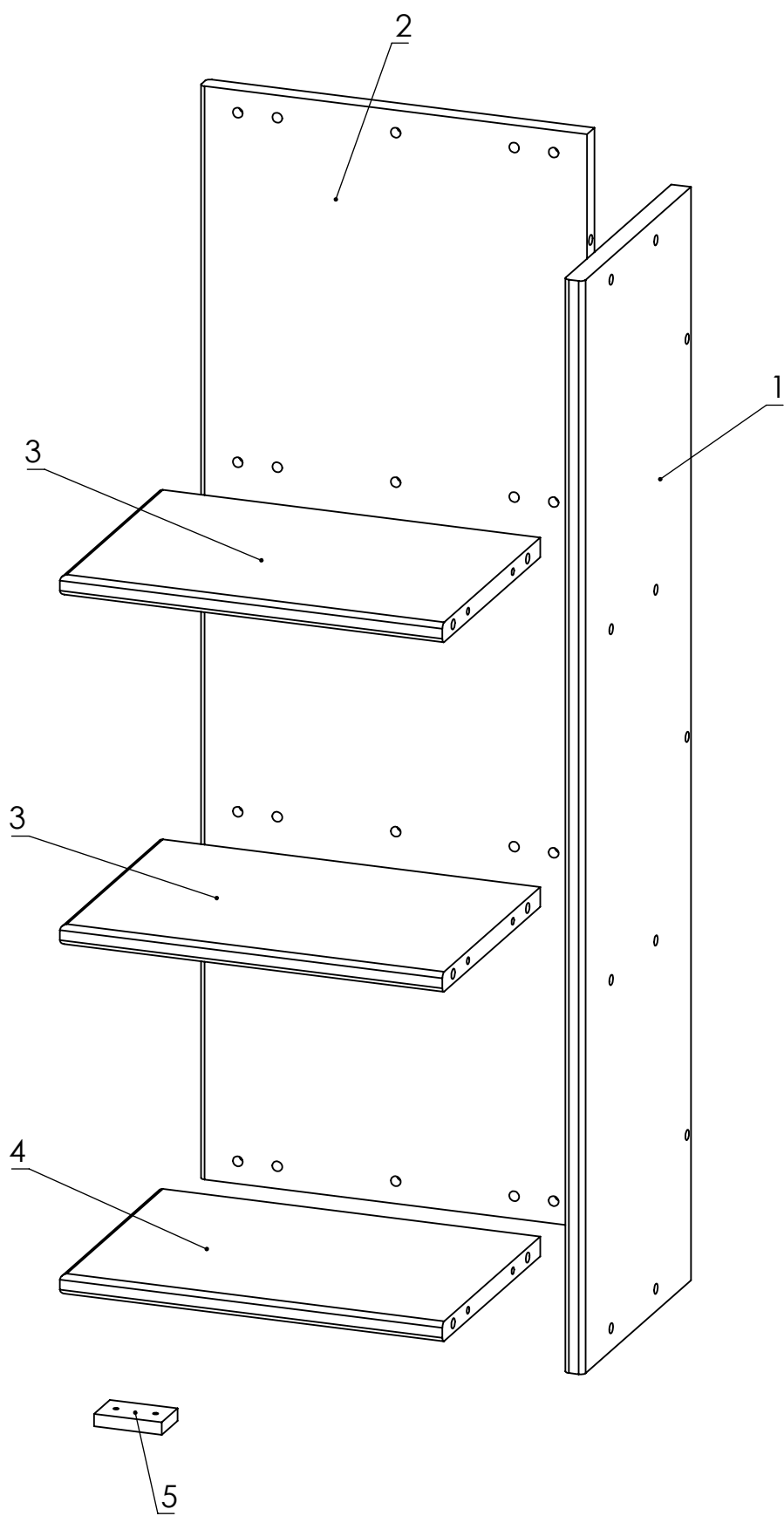

1.

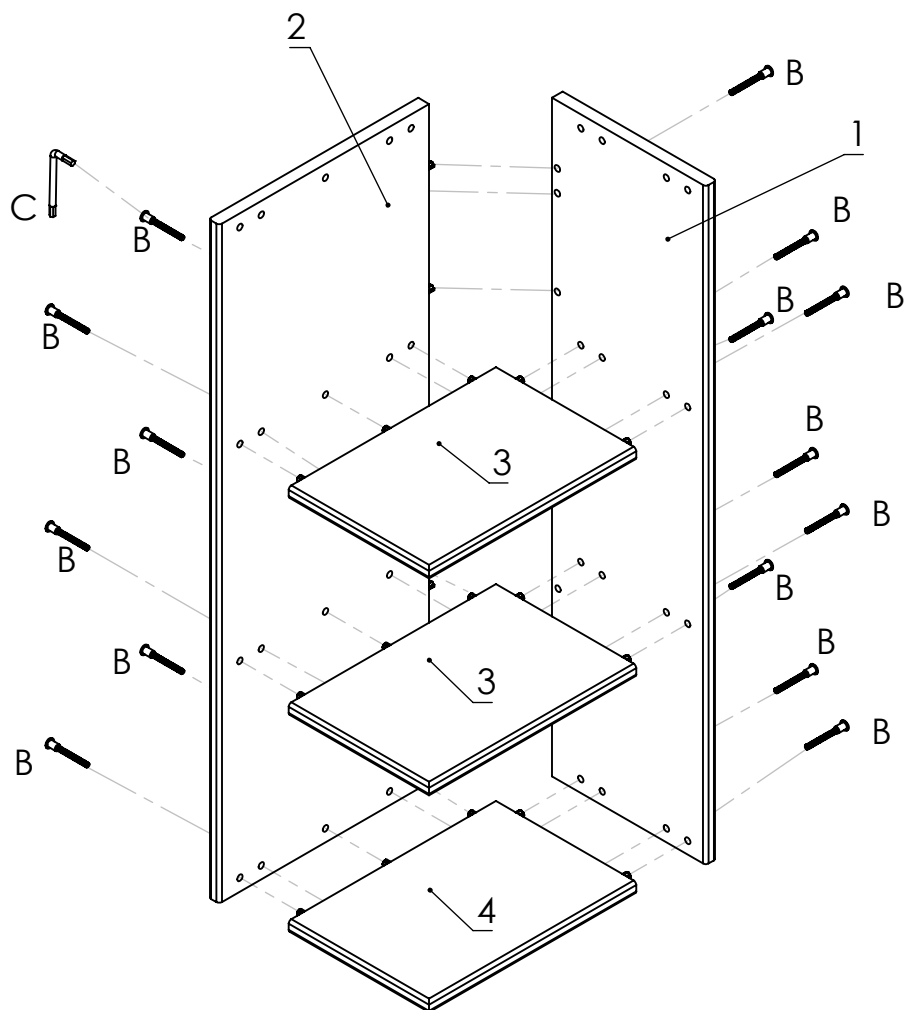
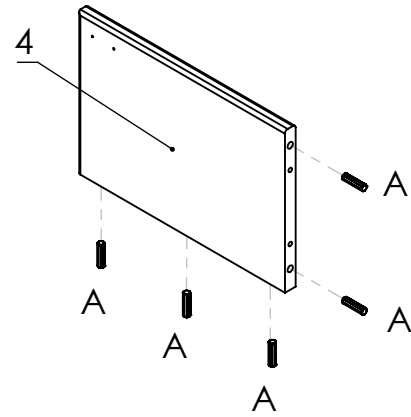
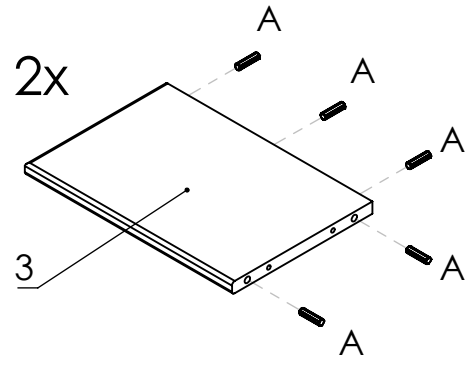
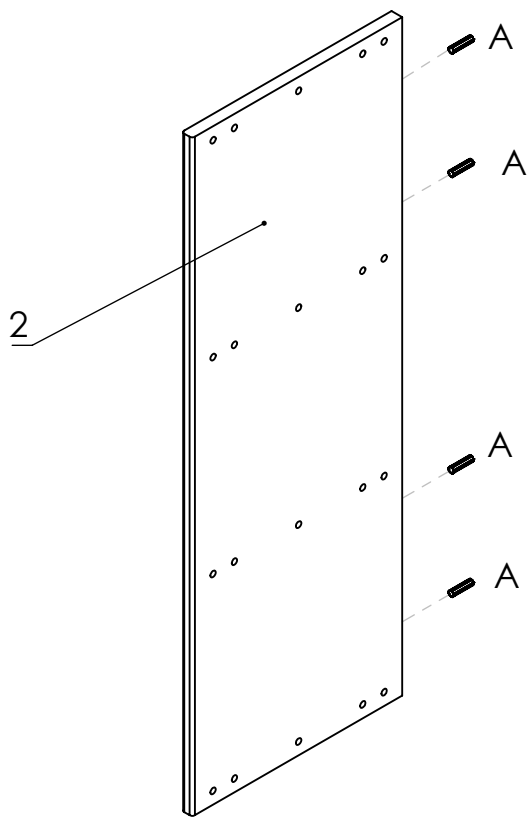

A x 19

B x 15

C x 1

2.

D x 2

