

## Maggy

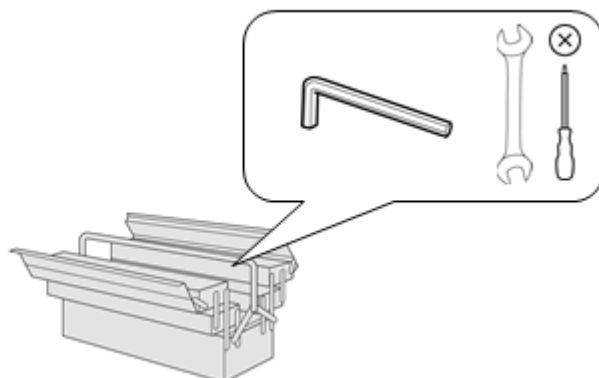

- |                             |                                  |
|-----------------------------|----------------------------------|
| (D) Montageanleitung        | (GB) Assembly instructions       |
| (FR) Notice de montage      | (NL) Handleiding voor de montage |
| (CZ) Montážní návod         | (IT) Istruzioni di montaggio     |
| (RO) Instrucțiuni de montaj | (RU) инструкция по сборке        |
| (PL) Instrukcja montażu     | (SK) Návod na montáž             |
| (HU) Szerelési útmutató     | (TR) Montaj talimati             |

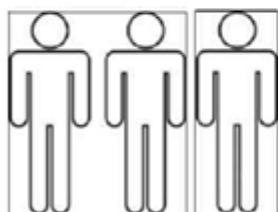

0  
10  
20  
30  
40  
50  
60  
70  
80  
90  
100  
110  
120  
130  
140  
150  
160  
170  
180  
190  
200

**Service • Assistenza • Dienstverlening • Serwis  
Servis • Szerviz • Сервисная служба**

|   |                        |
|---|------------------------|
| Name • Nom • Nome • Naam<br>Nazwa • Jméno • Názov • Név<br>Denumire • Ísim • Название | <b>Maggy<br/>zerl.</b> |
| Nr. • No. • N° • Номер • Č • Sz   | <b>SH55</b>            |
| Typ • Type • Tip • Típus • Тип  | <b>LARO</b>            |

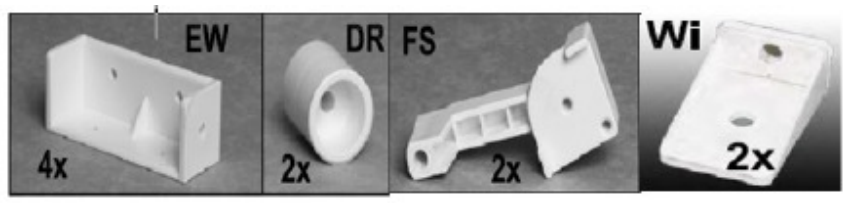
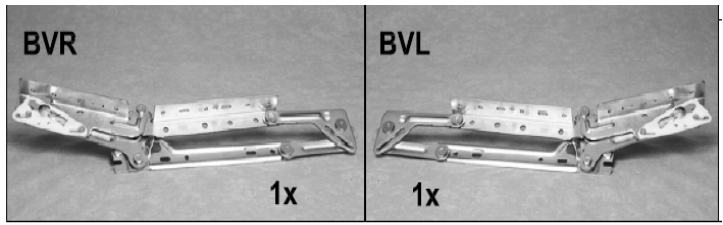
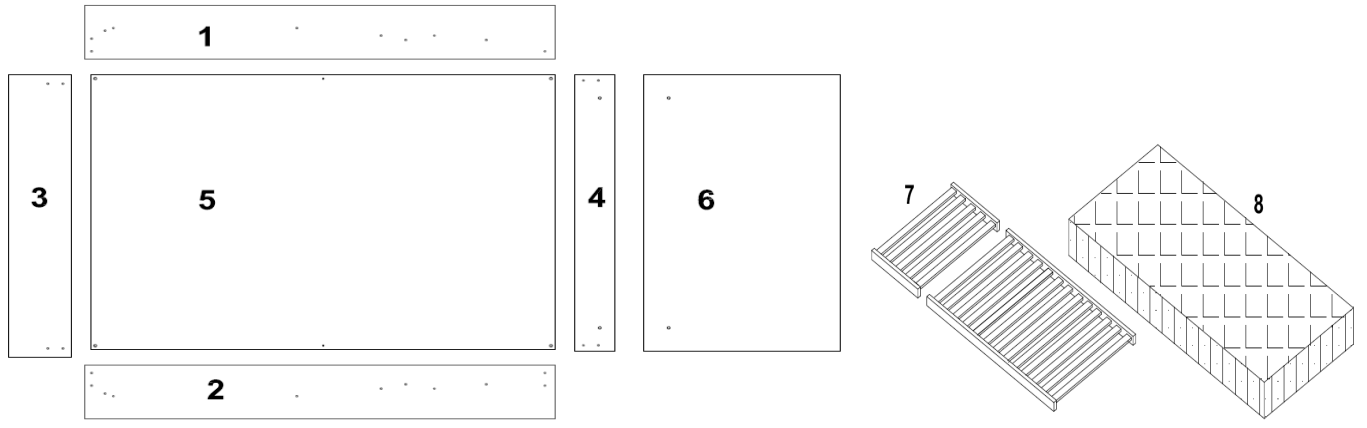
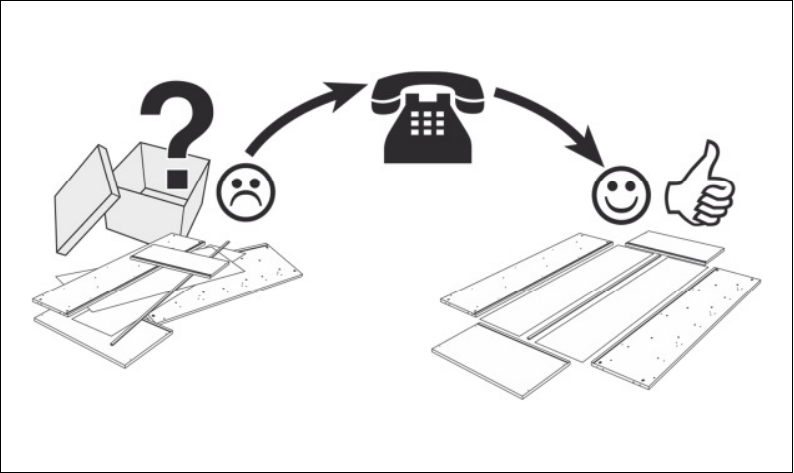
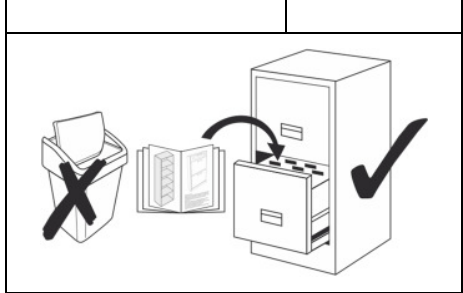

| A  | B        | C       | D       | E         | F       | G     | H       | I     | J         | K       | L     |
|----|----------|---------|---------|-----------|---------|-------|---------|-------|-----------|---------|-------|
|    |          |         |         |           |         |       |         |       |           |         |       |
| 4x | 20x 6x20 | 2x 6x35 | 2x 6x45 | 2x 4,5x45 | 4x 6x30 | 4x M6 | 2x 5x16 | 2x M5 | 2x 4,5x16 | 4x 8x60 | 4x M8 |

|       |
|-------|
| M     |
|       |
| 4x M8 |

1.

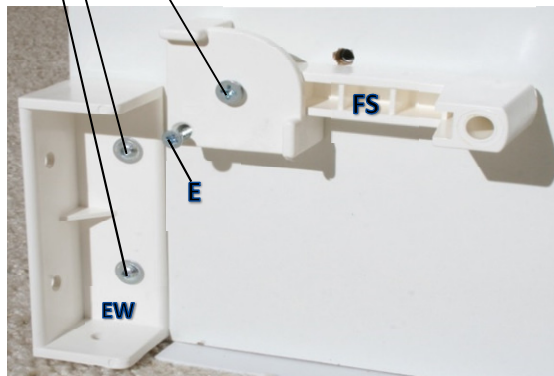
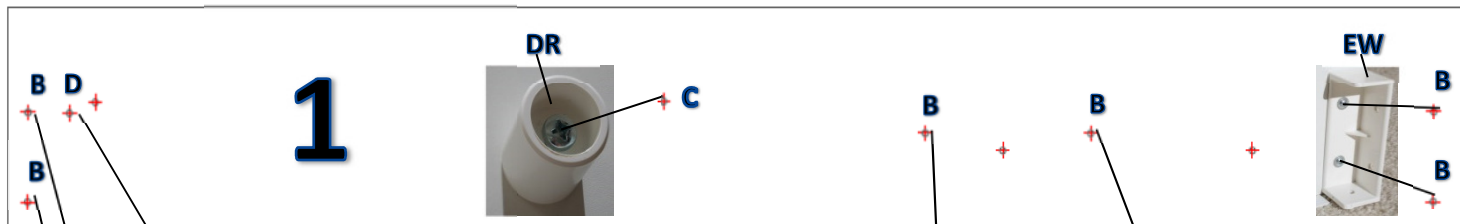

Handfest anziehen  
 Ne serrez pas  
 Nedotahujte  
 Nu strângeți  
 Nie dokręcać  
 Ne húzza meg  
 Do not tighten  
 Nog niet vastdraaien  
 Non serrare  
 Не затягивайте  
 Nedotahujte  
 Sıkmayın

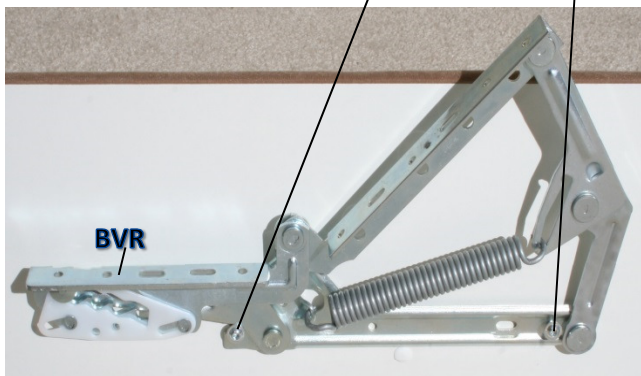
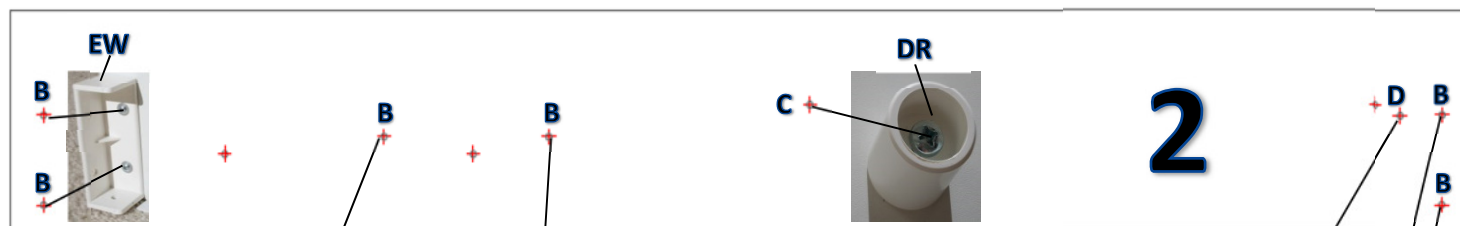
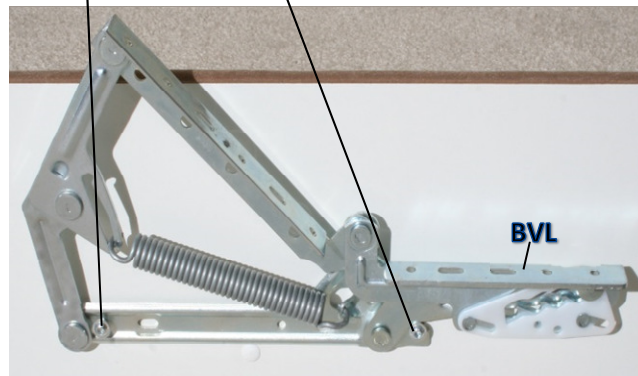

Handfest anziehen  
 Ne serrez pas  
 Nedotahujte  
 Nu strângeți  
 Nie dokręcać  
 Ne húzza meg  
 Do not tighten  
 Nog niet vastdraaien  
 Non serrare  
 Не затягивайте  
 Nedotahujte  
 Sıkmayın

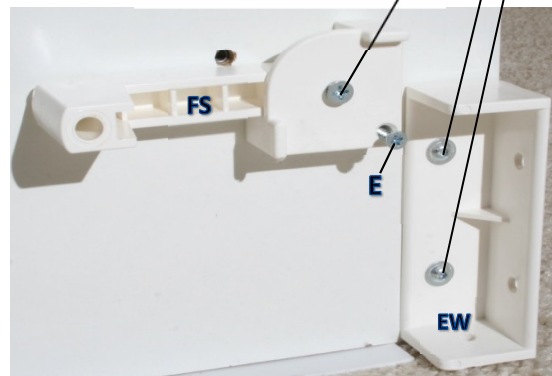

2.



Schrauben fest anziehen  
Serrer les vis  
Utáhněte šrouby  
Strângeți șuruburile  
Dokrećić šrubby  
Húzza meg a csavarokat  
Tighten the screws  
Draai de schroeven  
Serrare le viti  
Затянуть винты  
Utiahnite skrutky  
Vidaları sıkın

3.

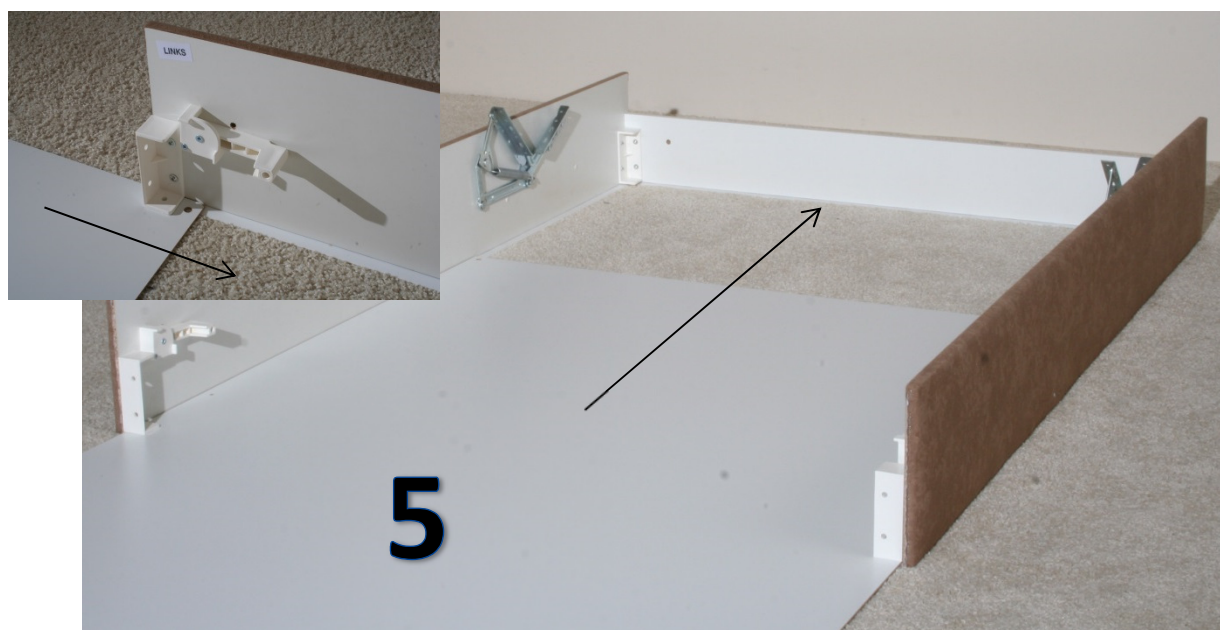



4.

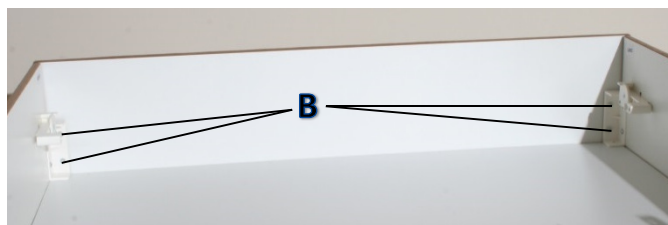
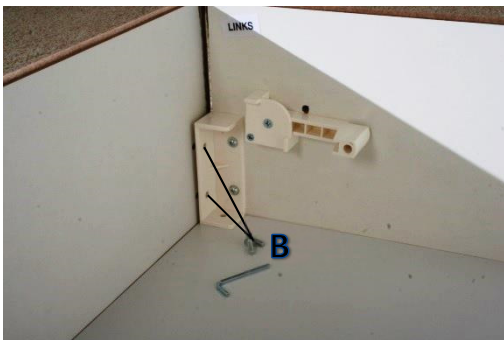

5.



6.

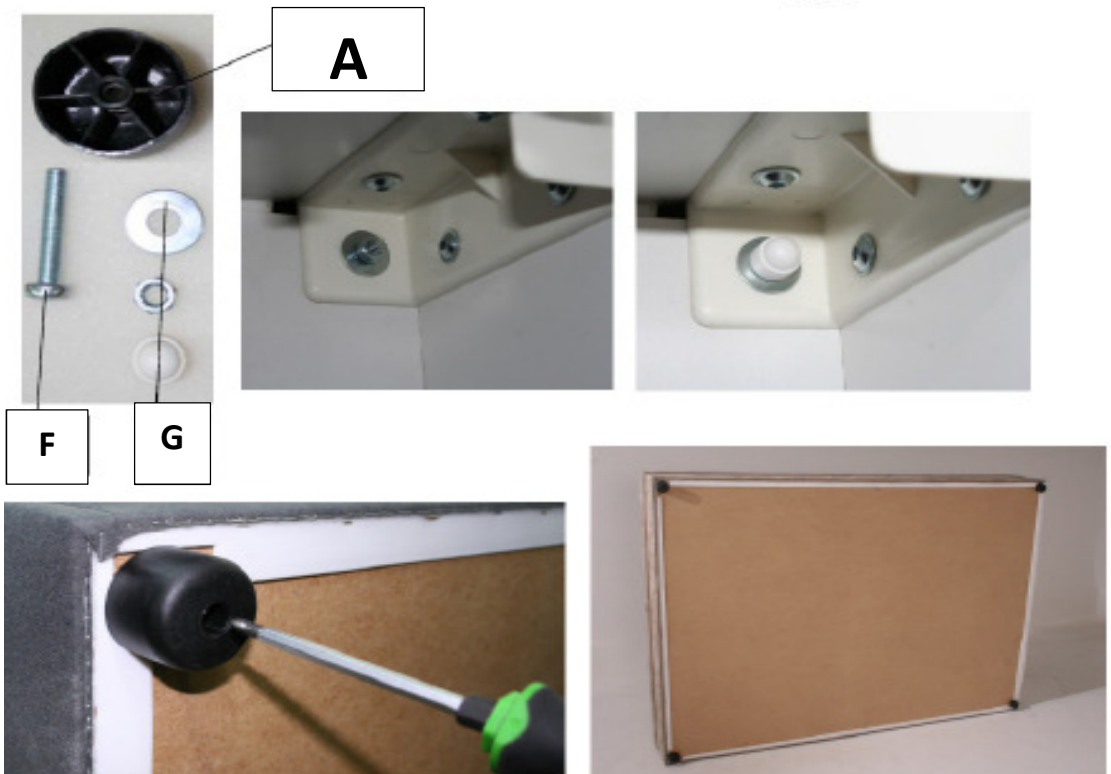



7.

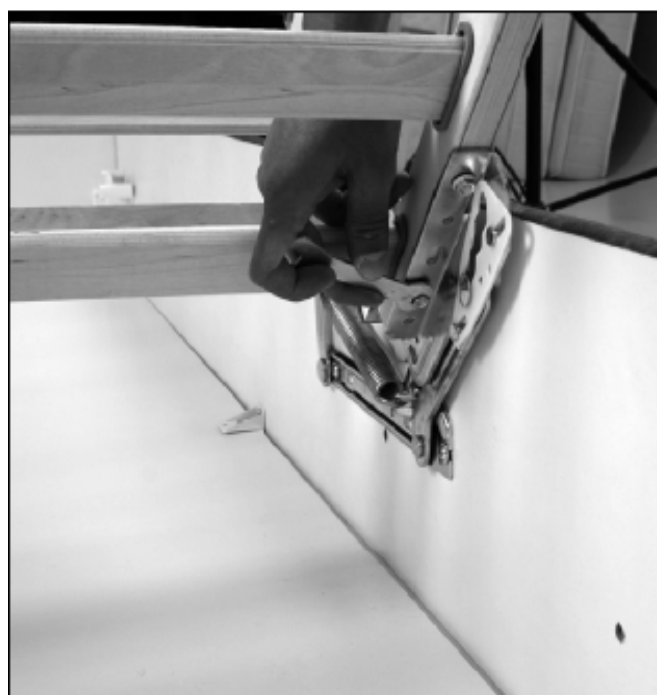







|   |   |   |   |
|---|---|---|---|
| <p>K</p>  <p>4x 8x60</p> | <p>L</p>  <p>4x M8</p> | <p>M</p>  <p>4x M8</p> | <p><b>Achtung!</b> Schrauben nicht überdrehen<br/> <b>FR</b> Attention! Ne serrez pas trop<br/> <b>CZ</b> Dávejte pozor! Nepřetahujte<br/> <b>RO</b> Ai grijaj! Nu strângeți<br/> <b>PL</b> Uwaga! Nie dokręcać zbyt mocno<br/> <b>HU</b> Vigyázz! Ne húzza túl</p> <p><b>GB</b> Watch Out! Do not over tighten<br/> <b>NL</b> Let Op! Niet te vast<br/> <b>IT</b> Attenzione! Non stringere<br/> <b>RU</b> Осторожно! Не затягивайте<br/> <b>SK</b> Dávaj Pozor! Nepretahujte<br/> <b>TR</b> Dikkat! Üzerinde sıkmayın</p> |
|---|---|---|---|

