

25.03.2013

Stand

00

Revision

APO

Verfasser

1 / 1

Seite(n)

höhenverstellbarer Stützfuß

Bezeichnung

FOB\_MO\_0011

lfd. Nr.

1

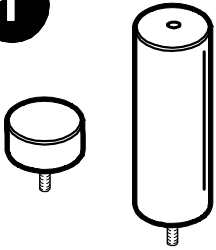

2

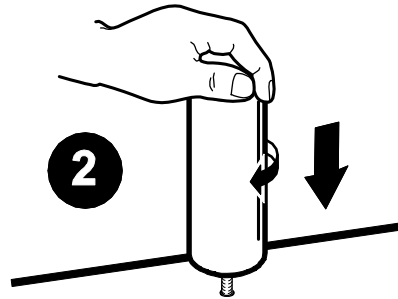

3

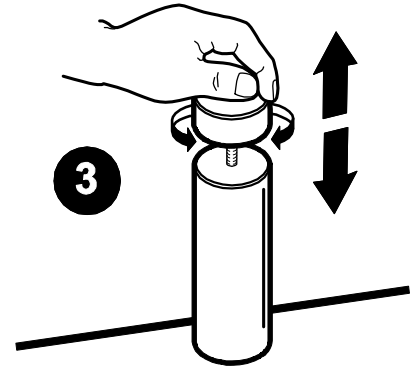

DE Fuß / Position

EN Foot / Position

NL Poot / Positie

IT Piedi / Posizione

RU Ноги / Позиция

FR Pied / Position

ES Pie / Posición

TR Ayak / Pozisyon

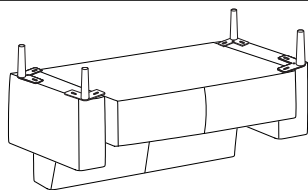

2-Sitzer medium ALR

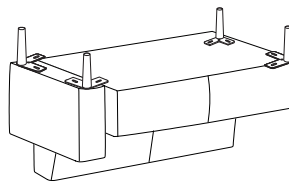

2-Sitzer medium AL/R

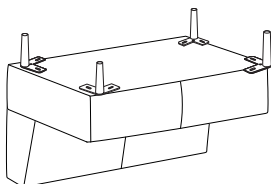

2-Sitzer medium ohne Armlehne

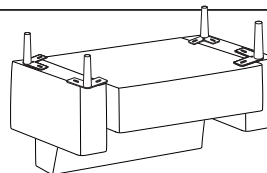

1,5-Sitzer (medium, maxi) ALR

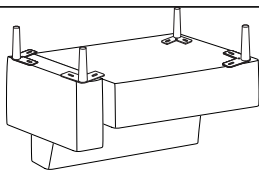

1,5-Sitzer (medium, maxi) AL/R

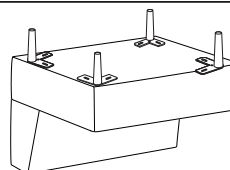

1,5-Sitzer (medium, maxi) ohne Armlehne

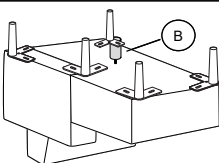

Longchair long (groß) AL/R  
Longchair (groß) AL/R

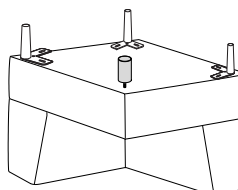

Spitzecke klein / Kombiecke

|              |                |              |      |              |                |          |  |          |  |          |  |
|--------------|----------------|--------------|------|--------------|----------------|----------|--|----------|--|----------|--|
| <b>A</b>     | Höhe<br>120 mm | <b>B</b>     | Höhe | <b>C</b>     | Höhe<br>120 mm | <b>D</b> |  | <b>E</b> |  | <b>F</b> | <b>Modellnummer</b><br>32595, 32596, 32734,<br>32735 |
|              |                |              |      |              |                |          |  |          |  |          | <b>Stand</b><br>04.01.2024                           |
| Metallfuß    |                | Stützfuß     |      | Metallfuß    |                |          |  |          |  |          | <b>Revision</b><br>11                                |
| Kundenseitig |                | Kundenseitig |      | Kundenseitig |                |          |  |          |  |          | <b>Verfasser</b><br>IKR                              |

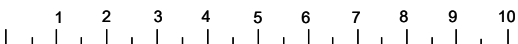

DE Fuß / Position

EN Foot / Position

NL Poot / Positie

IT Piedi / Posizione

RU Ноги / Позиция

FR Pied / Position

ES Pie / Posición

TR Ayak / Pozisyon

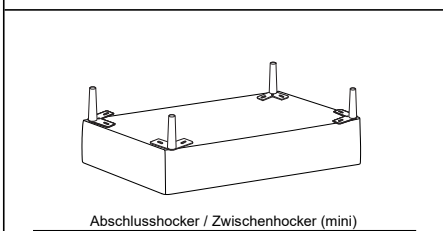
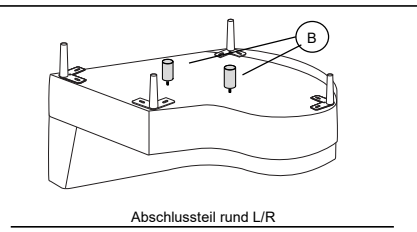
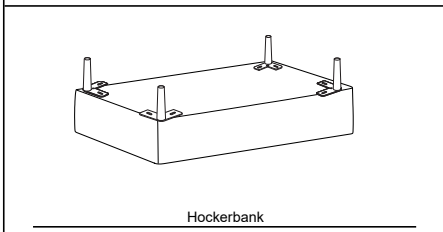
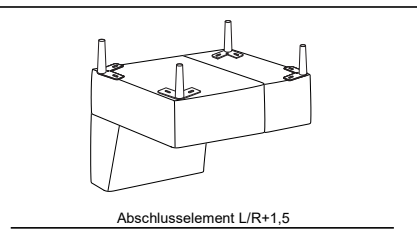
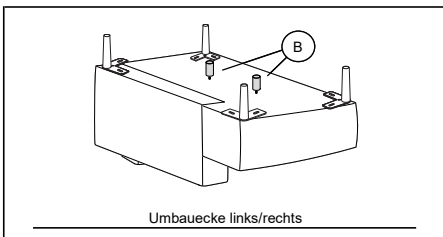

- (A) Metallfuß 908 schwarz matt **120mm**  
Metallfuß 906 Chrom glänzend **120mm**
- (C) Metallfuß 865 schwarz matt **120mm**  
Metallfuß 506 Chrom glänzend **120mm**

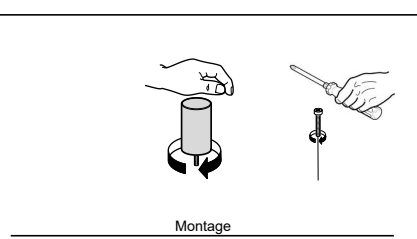
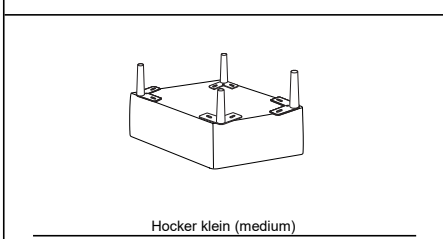

|                    |              |                       |     |     |     |  |
|--------------------|--------------|-----------------------|-----|-----|-----|--|
| (A) Höhe<br>120 mm | (B) Höhe     | (C) Höhe<br>120/150mm | (D) | (E) | (F) | <b>Modellnummer</b><br>32595, 32596, 32734,<br>32735 |
|                    |              |                       |     |     |     | <b>Stand</b><br>04.01.2024                           |
| Metallfuß          | Stützfuß     | Metallfuß             |     |     |     | <b>Revision</b><br>11                                |
| Kundenseitig       | Kundenseitig | Kundenseitig          |     |     |     | <b>Verfasser</b><br>IKR                              |

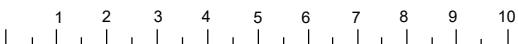

**FOB\_FU\_0539**

DE Fuß / Position

EN Foot / Position

NL Poot / Positie

IT Piedi / Posizione



RU Ноги / Позиция

FR Pied / Position

ES Pie / Posición

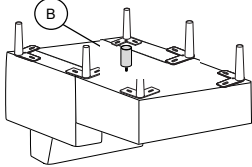
TR Ayak / Pozisyon

|   |  |
|---|--|
|  <p style="text-align: center;">Longseat</p> |  |
|   |  |
|   |  |
|   |  |

|   |   |   |        |        |   |  |
|---|---|---|--------|--------|---|--|
| A Höhe  | B Höhe  | C Höhe  | D Höhe | E Höhe | F | <b>Modellnummer</b><br>32595, 32596,<br>32734, 32735 |
|  |  |  |        |        |   | <b>Stand</b><br>04.01.2024                           |
| Metallfuß   | Stützfuß  | Metallfuß   |        |        |   | <b>Revision</b><br>11                                |
| Kundenseitig  | Kundenseitig  | Kundenseitig  |        |        |   | <b>Verfasser</b><br>IKR                              |

